

FEATURES

- Mechanical keyed color coded housings**
Prevents accidental mating of components operating at different voltage levels
- Single-piece housing and unitized construction**
Provides industrial quality and durability
- Genderless design**
Makes assembly quick and easy and reduces number of parts stocked
- Flat wiping contact system**
Allows for minimal contact resistance at high current, wiping action cleans contact surface during disconnection
- Silver plated contacts**
Offers greater longevity when using high power, elevated temperature applications
- UL approved for current interrupt**
Safe for "Hot Plug" of battery power
- Wide product range - for 50, 120, 175 and 350 amps**
Allows versatility to choose product best suited to design requirements
- UL94 V-0 housing material**
Provides security in knowledge that the connector chosen meets strict UL flammability ratings



PRODUCT RANGE

UL Current Rating (Amperes)*	50* to 350*
UL Voltage Ratings (Volts)	600*
Contact Barrel Wire Size (AWG)	#16 to 300 mcm
Contact Barrel Wire Size (mm ²)	1.3 to 152
Maximum Wire Insulation Diameter (inches)	0.44 to 1.10
Maximum Wire Insulation Diameter (mm ²)	11.18 to 27.94
AVG Contact Resistance* (micro-ohms)	200 to 50
Insulation Withstanding Test Voltage (Volts AC/DC)	2200
Contact Retention Force (lbs)	50 to 500
Life	
a. No load (Contact/Disconnect Cycles)	To 10,000
b. Under Load (Hot Plug) Max Amps (250 cycles @ 120V)	50A to 100A
Avg. Connection/Disconnect (lbs)	15 to 35
Operating Temperature Range °C**	-20° to 105°
Flammability Rating of Housing Material	UL94 V-0

* UL Rated for 65°C rated wire or cable size

** Contact factory for higher temperature rated connectors

SB®, UL and CSA Reference: This equipment is an Underwriters Laboratories Inc® recognized component. It is also listed by the Canadian Standards Association as certified.

Recommended Voltage Key Color Code

Voltage	12V	18V	24V	36V	48V	72V	80V	96V	120V	144V
Color	Yellow	Orange	Red	Gray	Blue	Green	Black	Brown	Purple	White

PRODUCT INFORMATION

Invented by Anderson Power Products®, the innovative SB® connectors provide cost-effective reliability, design flexibility and mistake-proof capability for your products' manufacture, installation and maintenance. APP's 2 & 3 pole connectors are available for 50, 120, 175 and 350 amp ratings for use to 600 Volts continuous AC or DC operation. There are SB® connectors for many applications and wire sizes, #16 (1.3mm) to 300 mcm (152mm). Mechanical keys ensure connectors will only mate with connectors of the same color. Different color housings are selected to identify voltages, thus preventing mismatching of the power supply system.

The housings are interchangeable, genderless interconnects. Insert contacts into housings and plug together for a clever, simple and low-cost solution to power interconnection. Low-detent contacts are also offered for low insertion/withdrawal force applications. Contacts are available in reeled and loose piece designs to support all production needs from very high volumes to engineering prototype and low-volume customized products.

Markets: UPS Systems, Telecommunications, Forklift Trucks, Wheelchairs, Electric Vehicles, Chargers, Power Electronics & Much More.

The innovative SB® connectors provide cost-effective reliability, design flexibility and safety for your products' manufacture, installation and maintenance.

APP's 2 pole connector is available with a 50 amp rating, 600 Volts continuous AC or DC operation. There are SB® connectors for many applications and wire sizes, #6 to #16 AWG (13.3 mm to 1.3 mm). Mechanical keys ensure connectors will only mate with connectors of the same color. Different color housings are selected to identify voltages, thus preventing mismatching of the power supply system.

FEATURES

- Mechanical keyed housings**
Prevents accidental mating of components operating at different voltage levels
- Single-piece housing and unitized construction**
Provides industrial quality and durability
- Genderless design**
Makes assembly quick and easy and reduces number of parts stocked



PRODUCT SPECIFICATIONS

Connector Model	SB ®50	Connector Model	SB ®50
UL Current Rating (Amperes)*	50*	Life	
UL Voltage Ratings (Volts)	600*	a. No load (Contact/Disconnect Cycles)	To 10,000
Contact Barrel Wire Size (AWG) (mm ²)	#6 to #16 13.3 to 1.3	b. Under Load (Hot Plug 250 cycles @ 120V)	50A
Maximum Wire Insulation Diameter (inches) (mm)	0.44 11.18	Avg. Connection/Disconnect - high detent	15 lbs.
AVG Contact Resistance* (micro-ohms)	200	- with lower extraction force	10 lbs.
Insulation Withstanding Test Voltage (Volts AC/DC)	2200	Operating Temperature Range °C**	-20° to 105°
Contact Retention Force (lbs)	50	Flammability Rating of Housing Material	UL94 V-0

* UL Rated for 65°C rated wire or cable size
** Contact factory for higher temperature rated connector
SB®, UL and CSA Reference: This equipment is an Underwriters Laboratories Inc® recognized component. It is also listed by the Canadian Standards Association as certified.

ORDERING INFORMATION

2 Pole Housing & 50 amp Contacts

Part Number	Housing Color	Wire	
		AWG	sq. mm
6319	Gray	#6	13.3
6319G1	Gray	#10/12	5.3/3.3
6331G1	Red	#6	13.3
6331G2	Red	#10/12	5.3/3.3
6331G3	Black	#6	13.3
6331G4	Black	#10/12	5.3/3.3
6331G5	Blue	#6	13.3
6331G6	Blue	#10/12	5.3/3.3
6331G7	Yellow	#6	13.3
6331G8	Yellow	#10/12	5.3/3.3
6331G9	Green	#6	13.3
6331G10	Green	#10/12	5.3/3.3
6331G11	Orange	#6	13.3
6331G12	Orange	#10/12	5.3/3.3

Housings Only

Part Number	Description
992	Gray
992G1	Red
992G2	Black
992G4	Blue
992G5	Yellow
992G6	Green
992G7	Orange

50 amp Contacts

Part Number	Description	Wire	
		AWG	sq. mm
903G1	Contact set (2)	#6	13.3
904G1	Contact set (2)	#10/12	5.3/3.3
5900	Individual	#6	13.3
1307	Individual-low detent	#6	13.3
5952	Individual	#8	8.4
5915	Individual	#10/12	5.3/3.3

50 amp contacts continued

Part Number	Description	Wire	
		AWG	sq. mm
265G1	Reel-silver plated	#6/8	13.3/8.4
265G2	Reel-silver plated	#10/12	5.3/3.3
265G3	Reel-silver plated-low det	#6/8	13.3/8.4
265G4	Reel-silver plated-low det	#10/12	5.3/3.3
265G5	Reel-tin plated	#6/8	13.3/8.4
265G6	Reel-tin plated	#10/12	5.3/3.3
265G7	Reel-tin plated-low det	#6/8	13.3/8.4
265G8	Reel-tin plated-low det	#10/12	5.3/3.3

Accessories

Part Number	Description
SB50-HDL-Red	Handle & hardware-red
134G1	Dust cover-red
990	Cable clamp & hardware-self attaching-2C

...continued on back page

ORDERING INFORMATION

accessories continued

Part Number	Description
990G1	Cable clamp & hardware-screw mounting-2C
5905	Cable clamp-1 twin conductor with hardware

Bushings

Part Number	Description	Wire	
		AWG	sq. mm
5910	Use with 5900 or 1307	#6 to #10/12	5.3/5.26 & 3.31
5912	Use with 5900 or 1307	#6 to #8	5.3/8.37
5913	Use with 5900 or 1307	#6 to #14/16	5.3/2.08 & 1.31

Tooling

Part Number	Description
1309G4	Hand tool
1387G1	Pneumatic tool
1388G6	- die for #6 to #16 AWG
1388G7	- die for #10 to #12 AWG
1389G6	- locator for #6 to #16 AWG
1389G7	- locator for #10 to #12 AWG
260G16	Applicator only (110V & 220V)
284G1	Applicator & Press (220V, 50Hz)
250G5	Press only (110V, 60Hz)

DIMENSIONS

SB[®]50 Housing

Series	-A-		-B-		-C-		-D-		-E-		-F-	
	mm	in.	mm	in.	mm	in.	mm	in.	mm	in.	mm	in.
SB [®] 50	19.0	0.75	6.4	0.25	18.2	0.72	36.5	1.44	47.6	1.88	80.9	3.19

Series	-G-		-H-		-J-	
	mm	in.	mm	in.	mm	in.
SB [®] 50	11.5	0.45	15.9	0.63	3.7	0.14

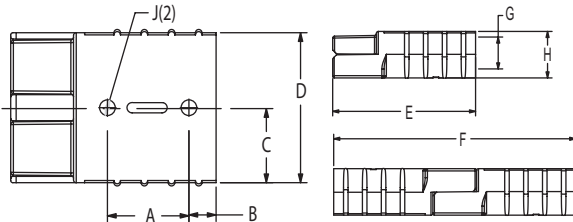

Bushings - (for use with 5900 or 1307)

Part Number	Reduces From	-A-		-B-		-C-	
		mm	in.	mm	in.	mm	in.
5910	#6 to #10-12 AWG	11.94	.47	5.41	.213	3.45	.136
5912	#6 to #8 AWG	11.43	.45	5.41	.213	4.57	.18
5913	#6 to #14-16 AWG	11.94	.47	5.41	.213	2.36	.093



TEMPERATURE RISE CHARTS

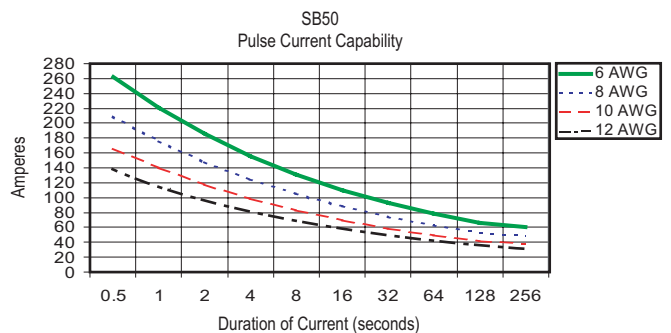
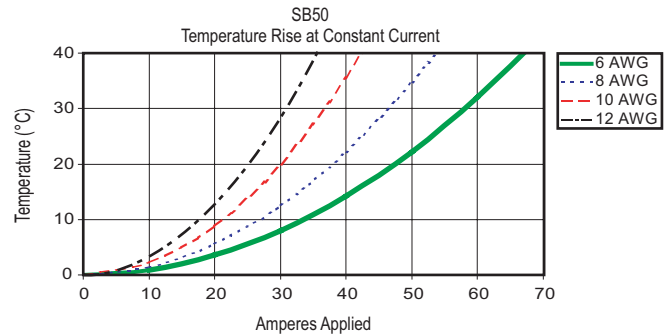

SB[®]50 Contacts

Part Number	-A-		-B-		-C-		-D-		-E-	
	mm	in.	mm	in.	mm	in.	mm	in.	mm	in.
1307	30.1	1.19	7.1	.28	5.6	.22	11.4	.45	7.1	.28
5900	30.7	1.21	7.1	.28	5.6	.22	11.4	.45	7.1	.28
5914	29.7	1.17	4.8	.19	3.5	.14	11.4	.45	7.1	.28
5915	29.5	1.16	7.1	.28	3.5	.14	11.4	.45	7.1	.28
5952	29.5	1.16	7.1	.28	4.8	.19	11.4	.45	7.1	.28
904G1	28.7	1.13	7.1	.28	3.6	.14	11.4	.45	7.1	.28
265G1	6.6	.26	9.1	.36	32.2	1.27	22.9	.9	7.6	.30
265G2	4.3	.17	7.4	.29	32.2	1.27	22.9	.9	7.6	.30
265G3	6.6	.26	9.1	.36	30.9	1.21	22.9	.9	7.6	.30
265G4	4.3	.17	7.4	.29	30.9	1.21	22.9	.9	7.6	.30
265G5	6.6	.26	9.1	.36	32.2	1.27	22.9	.9	7.6	.30
265G6	4.3	.17	7.4	.29	32.2	1.27	22.9	.9	7.6	.30
265G7	6.6	.26	9.1	.36	30.9	1.21	22.9	.9	7.6	.30
265G8	4.3	.17	7.4	.29	30.9	1.21	22.9	.9	7.6	.30

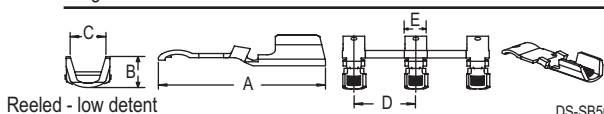
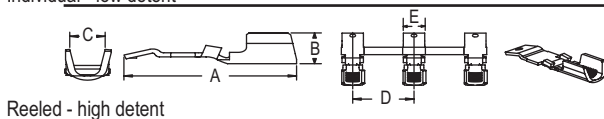
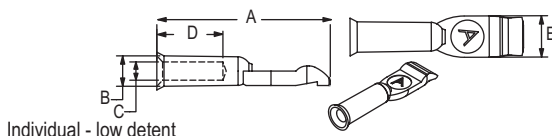
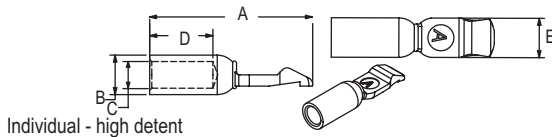

DS-SB50 REV01

The innovative SB® connectors provide cost-effective reliability, design flexibility and safety for your products' manufacture, installation and maintenance.

APP's 2 pole connector is available with a 120 amp rating, 600 Volts continuous AC or DC operation. There are SB® connectors for many applications and wire sizes, #2 to #6 AWG (33.6 to 13.3 mm²). Mechanical keys ensure connectors will only mate with connectors of the same color. Different color housings are selected to identify voltages, thus preventing mismatching of the power supply system.

FEATURES

- **Molded side grooves**

Allows for a secure panel mounting fit

- **Mechanical keyed housings**

Prevents accidental mating of components operating at different voltage levels

- **Single-piece housing and unitized construction**

Provides industrial quality and durability



PRODUCT SPECIFICATIONS

Connector Model	SB ®120	Connector Model	SB ®120
UL Current Rating (Amperes)*	120*	Life	
UL Voltage Ratings (Volts)	600*	a. No load (Contact/Disconnect Cycles)	To 10,000
Contact Barrel Wire Size (AWG)	#2 to #6	b. Under Load (Hot Plug 250 cycles @ 120V)	60A
(mm ²)	33.3 to 13.3	Avg. Connection/Disconnect (lbs)	20
Maximum Wire Insulation Diameter (inches)	0.575	Operating Temperature Range °C**	-20° to 105°
(mm)	14.6	Flammability Rating of Housing Material	UL94 V-0
AVG Contact Resistance* (micro-ohms)	136		
Insulation Withstanding Test Voltage (Volts AC/DC)	2200		
Contact Retention Force (lbs)	100		

* UL Rated for 75°C rated wire or cable size
** Contact factory for higher temperature rated connector
SB®, UL and CSA Reference: This equipment is an Underwriters Laboratories Inc® recognized component. It is also listed by the Canadian Standards Association as certified.

ORDERING INFORMATION

2 Pole Housing & 120 amp Contacts

Part Number	Housing Color	Wire	
		AWG	sq. mm
6800G1	Gray	#2	33.6
801G1	Blue	#2	33.6
6800G2	Gray	#4	21.1
6801G2	Blue	#4	21.1
6800G3	Gray	#6	13.3
6801G3	Blue	#6	13.3

Housing Only

Part Number	Description
6810G1	Gray housing
6810G2	Blue housing

120 amp Contacts

Part Number	Description	Wire	
		AWG	sq.mm
6811G1	Contact set (2)	#2	33.6
6811G2	Contact set (2)	#4	21.1
6811G3	Contact set (2)	#6	13.3

Bushings

Part Number	Description	Wire	
		AWG	sq. mm
5919	Use with 1319	#2 to #4	33.6/21.2
5920	Use with 1319	#2 to #6	33.6/13.3
5921	Use with 1319	#2 to #8	33.6/8.4

Accessories

Part Number	Description
SB120-HDL-RED	SB handle with hardware-red
981G1	Cable clamp for 2 single conductor cables

Tooling

Part Number	Description
1368	Hand tool - #2 to #8
1387G1	Pneumatic tool - #2 to #8
1388G4	- die for #2 to #8
1389G4	- locator #2 to #8

DIMENSIONS

Housing

	-A-		-B-		-D-		-E-		-F-	
Series	mm	in.	mm	in.	mm	in.	mm	in.	mm	in.
SB [®] 120	19.05	.75	35.81	1.41	44.45	1.75	63.5	2.50	104.65	4.12

	-H-		-J-		-K-		-L-		-M-	
Series	mm	in.	mm	in.	mm	in.	mm	in.	mm	in.
SB [®] 120	20.62	.81	5.05	.20	23.37	.92	2.54	.10	1.52	.06

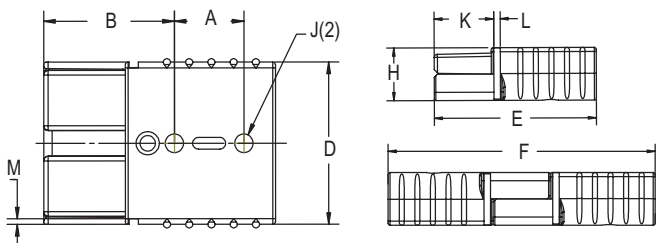

TEMPERATURE RISE CHARTS

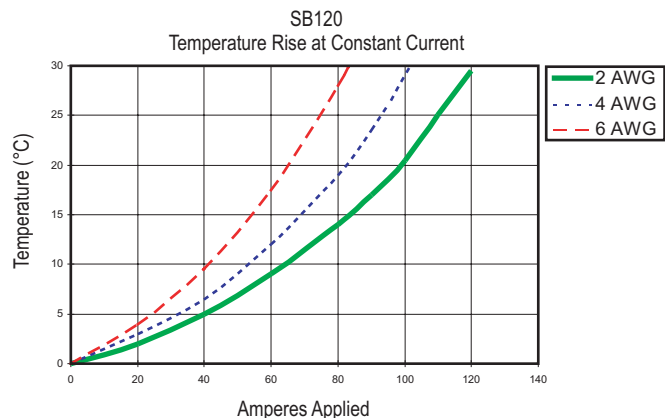

Contacts

Part Number	Contact Detent	-A- mm in.	-B- mm in.	-C- mm in.	-D- mm in.	-E- mm in.
6811G1	Low	49.27 1.94	21.34 .84	11.18 .44	8.64 .34	10.42 .41
6811G2	Low	49.27 1.94	21.34 .84	11.18 .44	8.64 .34	10.42 .41
6811G3	Low	49.27 1.94	21.34 .84	11.18 .44	8.64 .34	10.42 .41

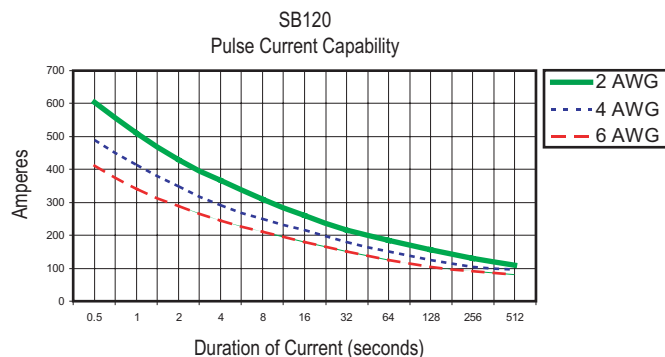
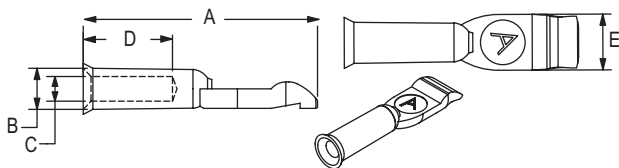

Bushings - (for use with 6811G1 contacts)

Part Number	Reduces From	-A- mm in.	-B- mm in.	-C- mm in.
5919	#2 to #4 AWG	21.34 .84	8.36 .329	7.24 .285
5920	#2 to #6 AWG	21.34 .84	8.36 .329	5.76 .227
5921	#2 to #8 AWG	21.34 .84	8.36 .329	4.6 .181



The innovative SB® connectors provide cost-effective reliability, design flexibility and safety for your products' manufacture, installation and maintenance.

APP's 2 & 3 pole connectors are available with a 175 amp rating, 600 Volts continuous AC or DC operation. There are SB® connectors for many applications and wire sizes, #4 to 1/0 AWG (21.1mm to 53.5mm). Mechanical keys ensure connectors will only mate with connectors of the same color. Different color housings are selected to identify voltages, thus preventing mismatching of the power supply system.

FEATURES

- Mechanical keyed housings**
Prevents accidental mating of components operating at different voltage levels
- Flat wiping contact system**
Allows for minimal contact resistance at high current, wiping action cleans contact surface during disconnection
- Genderless design**
Makes assembly quick and easy and reduces number of parts stocked



PRODUCT SPECIFICATIONS

Connector Model	SB ®175	Connector Model	SB ®175
UL Current Rating (Amperes)*	175*	Life	
UL Voltage Ratings (Volts)	600*	a. No load (Contact/Disconnect Cycles)	To 10,000
Contact Barrel Wire Size (AWG)	#4 to 1/0	b. Under Load (Hot Plug 250 cycles @ 120V)	75A
(mm ²)	21.1 to 53.5	Avg. Connection/Disconnect (lbs)	35
Maximum Wire Insulation Diameter (inches)	0.75	Operating Temperature Range °C**	-20° to 105°
(mm)	19.05	Flammability Rating of Housing Material	UL94 V-0
AVG Contact Resistance* (micro-ohms)	100		
Insulation Withstanding Test Voltage (Volts AC/DC)	2200		
Contact Retention Force (lbs)	300		

* UL Rated for 65°C rated wire or cable size
** Contact factory for higher temperature rated connector
SB®, UL and CSA Reference: This equipment is an Underwriters Laboratories Inc® recognized component. It is also listed by the Canadian Standards Association as certified.

ORDERING INFORMATION

2 Pole Housing & 175 amp Contacts

Part Number	Housing Color	Wire	
		AWG	sq. mm
6325G1	Gray	1/0	53.5
6326G1	Blue	1/0	53.5
6327G1	Orange	1/0	53.5
6328G1	Yellow	1/0	53.5
6329G1	Red	1/0	53.5
6325G5	Gray	#2	33.6
6326G5	Blue	#2	33.6
6327G5	Orange	#2	33.6
6328G5	Yellow	#2	33.6
6329G5	Red	#2	33.6
6325G6	Gray	#4	21.1
6326G6	Blue	#4	21.1
6327G6	Orange	#4	21.1
6328G6	Yellow	#4	21.1
6329G6	Red	#4	21.1

Housings Only

Part Number	Description
940	Gray
941	Blue
942	Orange
943	Yellow
949	Red
2-7252G11	Black, no voltage key

175 amp Contacts

Part Number	Description	Wire	
		AWG	sq. mm
944	Contact set (2)	1/0	53.5
947	Contact set (2)	#2	33.6
948	Contact set (2)	#4	21.1
948G1	Contact set (2)*	#6	13.3
944G1	Individual	#1	42.4
180BBS	Bus bar contact	N/A	N/A

* Thin wall

3 Pole Housing & 175 amp Contacts

Part Number	Description	Wire	
		AWG	sq. mm
6316	Housing with springs and 3 contacts	1/0	53.5

Accessories

Part Number	Description	
995G1	Handle, hardware & lock washers	Gray
995G3	Handle, hardware & lock washers	Red
923	Manual release, locking half with clamps and hardware	
924	Manual release, mounting half with clamps and hardware	
110G56	Keeps nut for use with Bus bar contact	

... continued on back page

ORDERING INFORMATION

accessories continued

Part Number	Description
111197	Charger key
134G2	Dust cover
945	Cable clamps
945G3	Cable clamps-2 single conductor with hardware. Use with "A" frame only
946G1	Cable clamps-1 twin conductor with hardware. Use with "A" frame only

Bushings

Part Number	Description	Wire	
		AWG	sq. mm
5648	Use with 1382	1/0 to #10	53.5/5.1
5663	Use with 1382	1/0 to #6	53.5/13.3
5687	Use with 1382	1/0 to #1	53.5/42.4
5690	Use with 1382	1/0 to #2	53.5/33.6
5693	Use with 1382	1/0 to #4	53.5/21.2

Tooling

Part Number	Description
1368	Hand tool for 1/0 to #1 (53.5/42.4)
1387G1	Pneumatic tool
1388G3	- die for 1/0 to #1 (53.5/42.4)
1389G3	- locator for 1/0 to #1 (53.5/42.4)

DIMENSIONS

SB®175 Housing

Series	-A-		-B-		-C-		-D-		-E-		-F-	
	mm	in.	mm	in.	mm	in.	mm	in.	mm	in.	mm	in.
SB®175	28.5	1.13	11.0	.44	27.8	1.09	55.6	2.19	79.4	3.13	133.3	5.25

Series	-G-		-H-		-J-	
	mm	in.	mm	in.	mm	in.
SB®175	19.0	.75	35.4	1.0	6.7	0.27

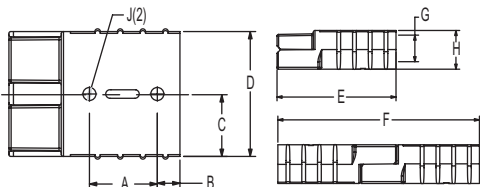

Bushings - (for use with 944 contact)

Part Number	Reduces From	-A-		-B-		-C-	
		mm	in.	mm	in.	mm	in.
5648	1/0 to #10 AWG	25.4	1.0	10.85	.427	4.75	.188
5663	1/0 to #6 AWG	25.4	1.0	10.85	.427	5.55	.218
5687	1/0 to #1 AWG	25.4	1.0	10.85	.427	9.9	.39
5690	1/0 to #2 AWG	25.4	1.0	10.85	.427	8.7	.343
5693	1/0 to #4 AWG	25.4	1.0	10.85	.427	6.9	.287

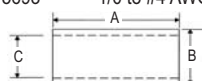

CSA Certified
File No. LR25154



UL Recognized
File No. E26226

All Data Subject To Change Without Notice

TEMPERATURE RISE CHARTS

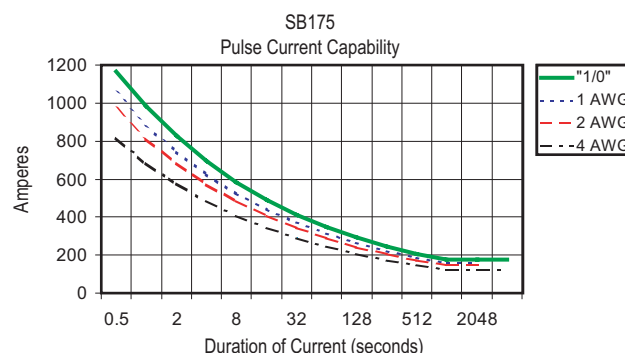
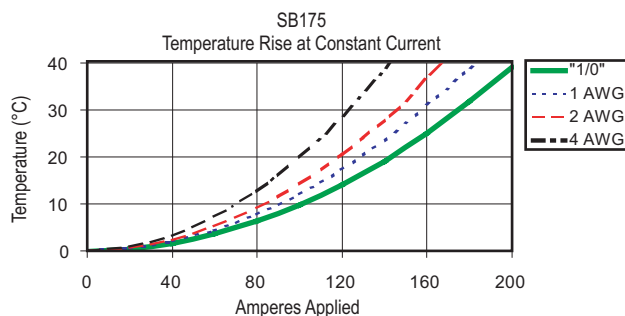

SB®175 Contacts

Part Number	-A-		-B-		-C-		-D-		-E-		-F-	
	mm	in.	mm	in.	mm	in.	mm	in.	mm	in.	mm	in.
944	59.6	2.35	13	.52	11.2	.44	26.4	1.04	12.7	.5	N/A	N/A
947	59.8	2.35	13	.51	8.9	.35	26.4	1.04	12.7	.5	N/A	N/A
948	59.7	2.35	13	.51	7.5	.3	26.4	1.04	12.7	.5	N/A	N/A
944G1	59.8	2.35	13	.51	9.9	.39	26.4	1.04	12.7	.5	N/A	N/A
948G1	53.3	2.1	9.3	.37	5.6	.22	20.3	.8	12.7	.5	N/A	N/A
180BBS	109.7	4.3	25.4	1.0	12.7	.50	N/A	1/4-20	N/A	N/A	4.6	.18

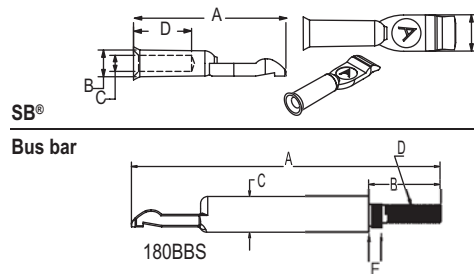

Bus bar Layout

Series	-J-		-L-		-M-	
	mm	in.	mm	in.	mm	in.
SB175	26.7	1.05	9.5	.38	3.4	0.14

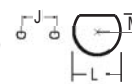

Bus bar Mounting Table

Series	-E-		-F-	
	mm	in.	mm	in.
SB175	89.8	3.5 ref	9.4	.4 ref

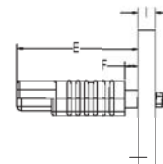

DS-SB175 REV02

The innovative SB[®] connectors provide cost-effective reliability, design flexibility and safety for your products' manufacture, installation and maintenance.

APP's 2 pole connector is available with a 350 amp rating, 600 Volts continuous AC or DC operation. There are SB[®] connectors for many applications and wire sizes, 2/0 AWG to 300 mcm (67.4 to 152 mm²). Mechanical keys ensure connectors will only mate with connectors of the same color. Different color housings are selected to identify voltages, thus preventing mismatching of the power supply system.

FEATURES

- Mechanical keyed housings**
Prevents accidental mating of components operating at different voltage levels
- Single-piece housing and unitized construction**
Provides industrial quality and durability
- Genderless design**
Makes assembly quick and easy and reduces number of parts stocked



PRODUCT SPECIFICATIONS

Connector Model	SB [®] 350	Connector Model	SB [®] 350
UL Current Rating (Amperes)*	350*	Life	
UL Voltage Ratings (Volts)	600*	a. No load (Contact/Disconnect Cycles)	To 10,000
Contact Barrel Wire Size (AWG) (mm ²)	2/0 to 300 mcm 67.4 o 152	b. Under Load (Hot Plug 250 cycles @ 120V)	100A
Maximum Wire Insulation Diameter (inches) (mm)	1.10 27.94	Avg. Connection/Disconnect (lbs)	30
AVG Contact Resistance* (micro-ohms)	50	Operating Temperature Range °C**	-20° to 105°
Insulation Withstanding Test Voltage (Volts AC/DC)	2200	Flammability Rating of Housing Material	UL94 V-0
Contact Retention Force (lbs)	500	<small>* UL Rated for 65°C rated wire or cable size ** Contact factory for higher temperature rated connector SB[®], UL and CSA Reference: This equipment is an Underwriters Laboratories Inc[®] recognized component. It is also listed by the Canadian Standards Association as certified.</small>	

ORDERING INFORMATION

2 Pole Housing & 350 amp Contacts

Part Number	Housing Color	Wire	
		AWG	sq. mm
6320G1	Gray	2/0	67.4
6320G2	Gray	4/0	107.2
6320G4	Gray	300 mcm	152.0
6320G5	Gray	3/0	85.0
6321G1	Blue	2/0	67.4
6321G2	Blue	4/0	107.2
6321G4	Blue	300 mcm	152.0
6321G5	Blue	3/0	85.0
6322G1	Red	2/0	67.4
6322G2	Red	4/0	107.2
6322G	Red	300 mcm	152.0
6322G5	Red	3/0	85.0
6323G1	Yellow	2/0	67.4
6323G2	Yellow	4/0	107.2
6323G4	Yellow	300 mcm	152.0
6323G5	Yellow	3/0	85.0

2 Pole Housing & 350 amp Contacts continued

Part Number	Description	Wire	
		AWG	sq. mm
6324G1	Green	2/0	67.4
6324G2	Green	4/0	107.2
6324G4	Green	300 mcm	152.0
6324G5	Green	3/0	85.0
6400G1	Orange	2/0	67.4
6400G2	Orange	4/0	107.2
6400G4	Orange	300 mcm	152.0
6400G5	Orange	3/0	85.0

Housings Only

Part Number	Color
906	Gray
912	Blue
913	Red

housings continued

Part Number	Color
914	Yellow
931	Green
932	Orange

Contacts

Part Number	Description	Wire	
		AWG	sq. mm
917	Contact set (2)	1/0	53.5
907	Contact set (2)	2/0	67.4
916	Contact set (2)	3/0	85.0
908	Contact set (2)	4/0	107.2
910	Contact set (2)	300 mcm	152.0

... continued on back page

ORDERING INFORMATION

Accessories

Part Number	Description
995G2	Handle & hardware-gray
995G4	Handle & hardware-red
919	Manual release-locking half-cable clamps, hardware & lock out spring for the battery
919G1	Mounting half-mounting half-hardware & lock out spring for battery
922G1	Mounting half-hardware for truck or charger
111197G1	Charger key
134G3	Dust cover
996G1	Cable clamps-2 single conductor with hardware
911	Cable clamps-2 single conductor, cables with hardware and steel handle

Bushings

Part Number	Description	Wire	
		AWG	sq. mm
5918	Use with 907	2/0 to 1/0	67.4/53.5

Tooling

Part Number	Description
1368	Hand tool for 1/0 to 300 mcm
1387G1	Pneumatic tool
1388G2	- die for 1/0 to 3/0
1389G2	- locator for 1/0 to 3/0
1388G1	- die for 4/0
1389G1	- locator for 4/0

DIMENSIONS

SB®350 Housing

Part Number	-A-	-B-	-C-	-D-	-E-	-F-
Series	mm in.	mm in.	mm in.	mm in.	mm in.	mm in.
SB®350	28.5 1.13	35.0 1.38	1.38 35.0	69.8 2.75	108.0 4.25	182.6 7.19

Series	-G-	-H-	-J-
SB®350	27.0 1.06	33.3 1.31	6.7 0.27

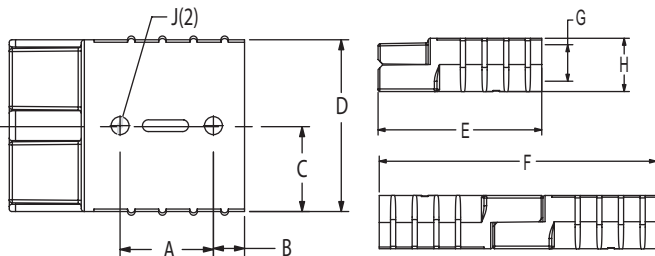

TEMPERATURE RISE CHARTS

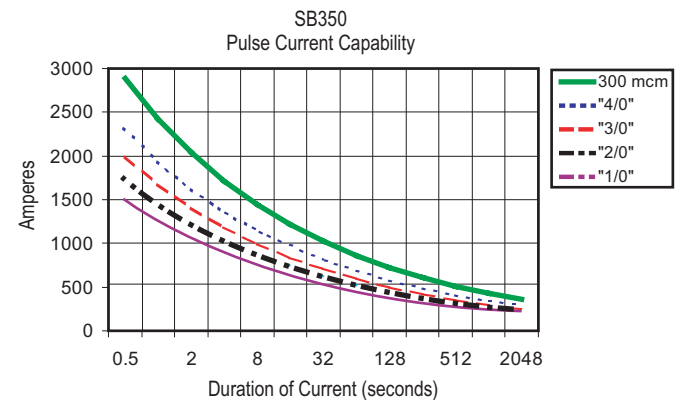
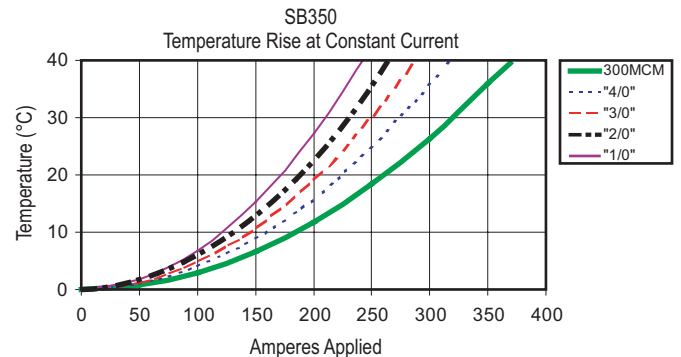

SB®350 Contacts

Part Number	-A- mm in.	-B- mm in.	-C- mm in.	-D- mm in.	-E- mm in.
907	75.1 2.96	16.3 .64	12.4 .49	32.8 1.29	20.6 .81
908	75.1 2.96	19.1 .75	16.3 .64	32.8 1.29	20.6 .81
910	73.9 2.91	22.2 .87	19.1 .75	32.5 1.28	20.6 .81
916	75.1 2.96	17.9 .7	14.7 .58	32.8 1.29	20.6 .81
917	73.9 2.91	13 .51	11.1 .44	31.8 1.25	20.6 .81

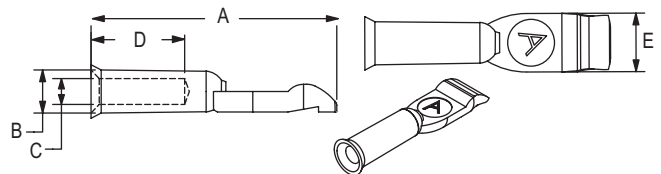

Bushing - (for use with 907 contact)

Part Number	Reduces From	-A- mm in.	-B- mm in.	-C- mm in.
5918	2/0 to 1/0 AWG	28.0 1.1	12.2 .48	11.2 .44



APP Bus bar series of contacts are designed for attachment to copper Bus. They handle 75 amps up to 180 amps and are used with standard APP connector housings. The Bus bar contacts replace terminals and lugs which had required an electrician to disconnect. Durable APP connector housings provide color-coding and mechanical keying with our SB® series. Our Powerpole® connector housings can be interlocked with its unique dovetail feature. Users will also appreciate the flexibility of the mating wire side with contacts available from #16 AWG (1.3 mm²) up to 1/0 AWG (53.5 mm²) wire sizes.

* Tested per UL1977 - overload and resistance to ARC - Based on singlepole

FEATURES

- **Disconnect contacts**
Provide for modular assembly or simple field repair lowering manufacturing and maintenance costs
- **Hot swap ***
Allows for repair and maintenance of components without the need for powering down equipment
- **Solid copper contacts with silver plating**
Superior conductivity for lower heating



PRODUCT SPECIFICATIONS

Contact Information	PP75	PP180	SB® 50	SB®120	SB®175	SB®350
Maximum Current (per contact)	75 amps	180 amps	50 amps	120 amps	175 amps	350 amps
Maximum Voltage (AC or DC)	600					
Contact Material	99 % copper					
Plating	Silver					
Contact Resistance	<100 micro-ohms					
Mating Life-No Load (cycles)	10,000					
**Mating Life-Under Load-cycles (70 amps)	250 min					
Mating Connector Information						
Contact Barrel Wire Size (AWG)**	#6 to #16	1/0 to #10	#6 to #16	#2 to #6	1/0 to #10	2/0 to 300mcm
Contact Barrel Wire Size (mm ²)**	13.3 to 1.3	53.5 to 5.3	13.3 to 1.3	33.3 to 13.3	53.5 to 5.3	67.4 to 152
Housing Information						
Powerpole and SB housings are manufactured using polycarbonate resin that meets UL94 V-0 requirements. Temperature range is -20° to 105°C / -4° to 221°F. ** Tested per UL1977 - singlepole configuration *** Reducing bushing must be used to accommodate smaller wire sizes						

ORDERING INFORMATION

Bus Bar Contact

Part Number	Description
75BBS	75 amp contact
120BBS	120 amp contact (SB only)
180BBS	180 amp contact
350BBS	350 amp contact (SB only)

Powerpole® PP180 Housings

Part Number	Description
1381	PP180 Housing, Blue
1381G1	PP180 Housing, Black
1381G2	PP180 Housing, White
1381G3	PP180 Housing, Red
1381G4	PP180 Housing, Green

SB® 175 Housings

Part Number	Description
940	SB Housing, Gray
941	SB Housing, Blue
942	SB Housing, Orange
943	SB Housing, Yellow
949	SB Housing, Red

Lock Nuts

Part Number	Description
110G57	For use with PP75 / SB50 contact
110G72	For use with SB120 contact
110G56	For use with PP180 / SB175 contact
110G73	For use with SB350 contact

SB® 50 Housings

Part Number	Description
992	Gray
992G1	Red
992G2	Black
992G4	Blue
992G5	Yellow
992G6	Green
992G7	Orange

SB® 350 Housings

Part Number	Description
906	Gray
912	Blue
913	Red
914	Yellow
931	Green
932	Orange

Powerpole® PP75 Housings

Part Number	Description
5916	PP75 Housing, Blue
5916G4	PP75 Housing, Black
5916G5	PP75 Housing, White
5916G6	PP75 Housing, Green
5916G7	PP75 Housing, Red

SB® 120 Housings

Part Number	Description
6810G1	Gray
6810G2	Blue
6810G3	Red

HEADQUARTERS: 13 Pratts Junction Road, P.O. Box 579, Sterling, MA 01564 T:978-422-3600 F:978-422-3700

EUROPE: Rathealy Road, Fermoy Co. Cork, Ireland T:353-(0)25-32277 F:353-(0)25-32296

ASIA/PACIFIC: IDEAL Anderson Asia Pacific Ltd., Unit 922-928 Topsail Plaza, 11 On Sum Street, Shatin N.T., Hong Kong

T:852-2636-0836 F:852-2635-9036

www.andersonpower.com

ORDERING INFORMATION

Contacts

Part Number	- A -		- B -		- C -		- D -	- E -		- F -		
	in.	mm	in.	mm	in.	mm		in.	mm	in.	mm	
75BBS	75	2.70	68.6	0.67	17.0	0.27	6.9	#10-24 thd.	0.04	1.0	0.08	2.0
120BBS	120	3.03	77.0	0.44	11.2	0.38	9.7	#10-24 thd.	N/A		0.10	2.5
180BBS	180	4.30	109.2	1.00	25.4	0.50	12.7	1/4-20 thd.	N/A		0.18	4.6
350BBS	350	5.19	131.8	0.88	22.4	0.67	17.0	3/8-16 thd.	N/A		0.10	2.5

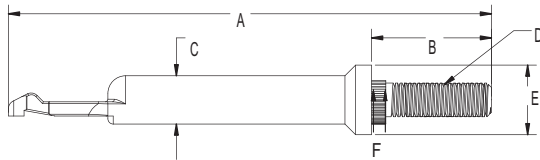

75BBS

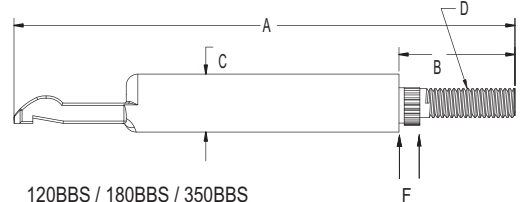

120BBS / 180BBS / 350BBS

Mounting Table

Part Number	Amps	- E -		- F -		- G -		- H -		- J -	
		in.	mm	in.	mm	in.	mm	in.	mm	in.	mm
75BBS	75	2.10	53.3	0.20	5.1	2.10	53.3	0.20	5.1	.12-.50	3.0-12.7
120BBS	120	2.70	68.6	0.20	5.1	N/A		N/A		.12-.77	3.0-19.6
180BBS	180	3.50	88.9	0.40	10.2	3.50	88.9	0.30		.12-.77	3.0-19.6
350BBS	350	4.45	113.0	0.20	5.1	N/A		N/A		.12-.77	3.0-19.6

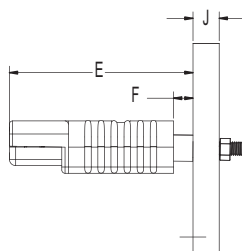

SB® View

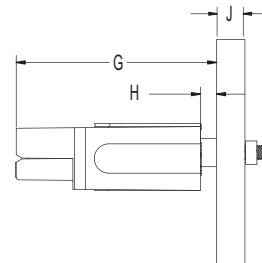

Powerpole® View

Bus Bar Layout

Part Number	Amps	- K -		- L -		- M -	
		in.	mm	in.	mm	in.	mm
75BBS	75	0.63	16.0	0.21	5.2	0.12	2.9
120BBS	120	0.83	21.1	0.29	7.2	0.11	2.8
180BBS	180	1.05	26.7	0.37	9.4	0.14	3.6
350BBS	350	1.33	33.8	0.52	13.2	0.21	5.2

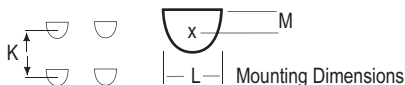

Lock Nut

Part Number	Lock Nut	- A -		- B -	
		in.	mm	in.	mm
75BBS	#10-24 thd.	0.38	9.7	0.16	4.0
120BBS	#10-24 thd.	0.38	9.7	0.16	4.1
180BBS	1/4-20 thd.	0.44	11.1	0.23	6.0
350BBS	3/8-16 thd.	0.55	14.0	0.40	10.0



FEATURES

- **Complies with OSHA, ANSI and DOE standards and codes for lockout/tagout of equipment under repair**

Simple, cost-effective means of assuring equipment under repair cannot be operated by unauthorized personnel

- **Two designs**

2 sizes accommodates all SB[®]175 and SB[®]350 connectors

- **Sleek design**

Easily fits into technicians tool box

- **Padlock through hole**

Works with standard padlock



PRODUCT RANGE

For Use With	SB175 & 350
Material	Nylon 66
Operating Temperature Range °C	-20° to 105°

ORDERING INFORMATION

SB175 & SB350 Accessory

Part Number	Description
SB175-lockout	Safety lockout
SB350-lockout	Safety lockout

PRODUCT INFORMATION

Anderson Power Products (APP) is pleased to announce two additions to our long line of power connector accessories; the SB175 and SB350 lockouts. These lockouts fit over our SB175 or SB 350 connectors preventing touching of the power contacts or mating of the connector. The lockouts are designed to be secured with a standard padlock.

The purpose of these lockouts is to safeguard employees from injury or possibly death. In many applications, the Occupational Safety and Health Administration (OSHA) require lockouts to be used. One application would be during the service and maintenance of machinery or equipment when unexpected energizing, start up, or release of stored energy may occur. A lockout is also required if an employee is required to place any part of their body into an area on a machine or equipment where work is being performed.

With the addition of these lockouts, APP is continuing to provide our customers with safe and reliable power connector solutions.

The SBO®60 connector is for hot-plug use at 60 amps. It contains recessed contacts and a ribbed nose housing, thus providing finger proofing in environments where human contact is a consideration. Available in different colors, this genderless connector is mechanically keyed to ensure connectors will only mate with connectors of the same color.

With the silver-plated copper contacts, there is a maximum connect/disconnect life of 10,000 cycles, with a 600 volts continuous AC or DC operation. Accessories, such as integral cable clamp and handle, provide strain relief and ease of use.

FEATURES

- Auxiliary contacts**
Provides additional poles up to 30 amps for auxiliary power, control or sensing
- Meets UL 1950 finger probe test**
Each half offers finger proofing and can be connected to two energized sources up to 600 volts AC/DC
- Handle**
Eases connector use and relieves unnecessary strain on cables when disconnecting

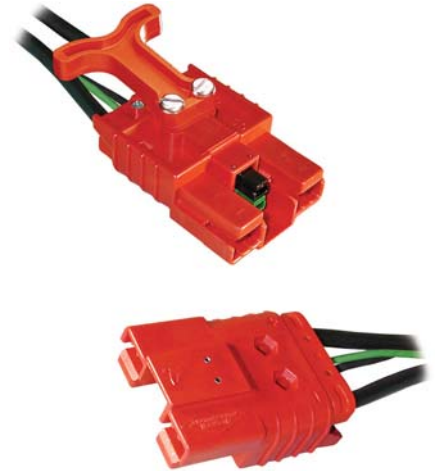

PRODUCT SPECIFICATIONS

Connector Model	SBO®60	Connector Model	SBO®60
Current rating (main contacts)	60	Insulation with standing test voltage (volts AC/DC)	2200
Largest wire size (AWG)	#6	Maximum wire insulation diameter (inches)	0.44
(mm ²)	16	(mm)	11.18
Maximum operating voltage AC/DC	600	Contact retention force (lbs)	50
Contact material	Silver plated copper	Life:	
Operating temperature range °C	-20° to 105°	a. No load (connect/disconnect cycles)	10,000
Flammability rating of housing material	UL94 V-0	b. Under load (hot plug 250 cycles @ 120V)	60A
AVG contact resistance* (microhoms)	200		
		<small>*UL rated for 65°C rated wire or cable size</small>	

ORDERING INFORMATION

Housing Only

Part Number	Housing Color
SBO60RED	Red
SBO60YEL	Yellow
SBO60ORN	Orange
SBO60WHT	White

Contacts

Part Number	Description	Wire AWG	sq. mm
1339G1	Contact set (2)	#6	16

Bushings

Part Number	Description	Wire AWG	sq. mm
5912	Use with 1339G1	#6 to #8	3.3/8.4
5910	Use with 1339G1	#6 to #10/12	13.3 to 5.3/3.3

Cable Clamp & Hardware

Part Number	Housing Color
SBO60CLPRED	Red

Handle/Hardware & Accessories

Part Number	Description
SBO60HDLRED	Red housing
6344	Auxiliary contact kit

Housing, Contacts, Handle, Clamp & Hardware

Part Number	Housing Color
SBO60RED16MMHDL	Red

Tooling

Part Number	Description
1309G4	Hand tool
1387G1	Pneumatic tool
1388G6	- die for #6 AWG/16 mm
1389G9	- locator for #6 AWG/16 mm

DIMENSIONS

	-A-		-C-		-D-		-E-		-F-	
Series	mm	in.	mm	in.	mm	in.	mm	in.	mm	in.
SBO®60	46.0	1.81	14.6	.58	49.5	1.95	58.9	2.32	112.3	4.41

	-G-		-H-		-I-	
Series	mm	in.	mm	in.	mm	in.
SBO®60	26.3	1.03	5.1	.20	10.6	.42

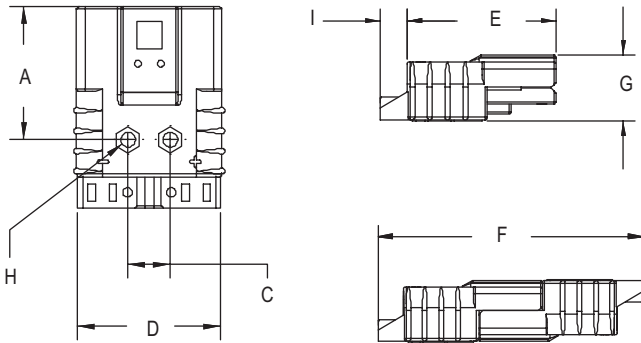

TEMPERATURE RISE CHART

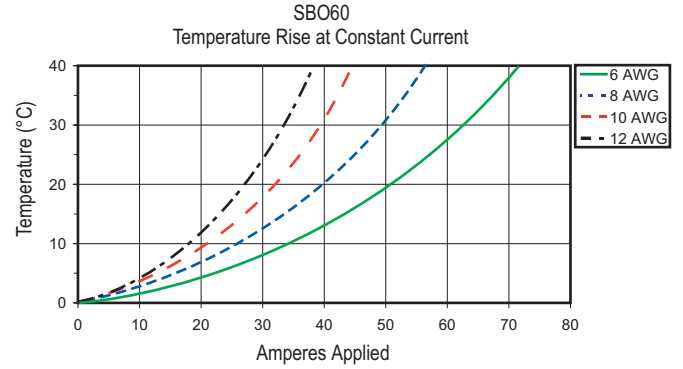

The Patent Pending SBS™50 is designed for high voltage applications where personal safety is critical. The connector meets the accessibility requirements of UL1977 sec 10.2 and is recommended for over 50 volts.

The slim, ergonomic design, along with Anderson's flat wipe contact technology makes hot plugging and unplugging easy and safe. The SBS™ 50 is manufactured using the same high quality materials that provide APP customers the robustness needed for systems demanding reliability and longevity.

Applications for this connector include: AC & DC power distribution, uninterruptible power supplies (UPS) and traction batteries.

FEATURES

- Finger proof**
Minimizes the potential contact with live contacts, per UL 1977, sec 10.2
- Mechanical keyed housings**
Prevents accidental mating of connectors operating at different voltage levels
- Ergonomic design**
Is "user friendly" during connection and disconnection of the system
- Molded side grooves**
Allows for direct panel mounting, for panel thicknesses of .048 to .062 inches (mm) or a panel mount bracket

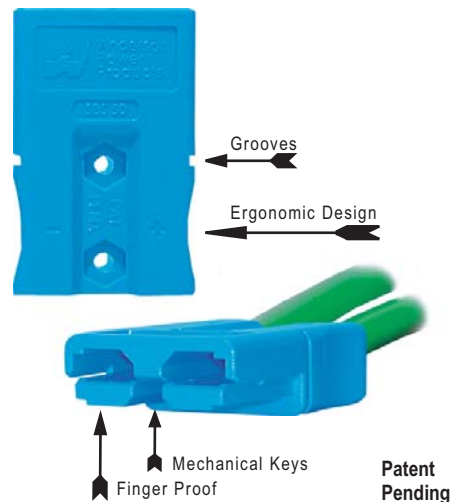

PRODUCT SPECIFICATIONS

Connector Model	SBS 50	Connector Model	SBS 50
UL Current Rating (Amperes)*	50*	Life	
UL Voltage Ratings (Volts)	600*	a. No load (Contact/Disconnect Cycles)	To 10,000
Contact Barrel Wire Size (AWG)	#6 to #16	b. Under Load (Hot Plug 250 cycles @ 120V)	50A
(mm ²)	13.3 to 1.3	Avg. Connection/Disconnect (lbs)	15
Maximum Wire Insulation Diameter (inches)	0.44	Operating Temperature Range °C**	-20° to 105°
(mm)	11.18	Flammability Rating of Housing Material	UL94 V-0
AVG Contact Resistance* (micro-ohms)	200	* UL Rated for 65°C rated wire or cable size	
Insulation Withstanding Test Voltage (Volts AC/DC)	2200	** Contact factory for higher temperature rated connector	
Contact Retention Force (lbs)	50	SB®, UL and CSA Reference: This equipment is an Underwriters Laboratories Inc® recognized component. It is also listed by the Canadian Standards Association as certified.	

ORDERING INFORMATION

2 Pole Housing & 50 amp Contacts				Housings Only				Accessories					
Part Number	Housing Color	Wire AWG	Wire sq. mm	Part Number	Description	Part Number	Description	Part Number	Description	Part Number	Description	Wire AWG	Wire sq. mm
SBS50GRA#6	Gray	#6	13.3	SBS50GRA	Gray	SBS50-HDL-Red	Handle & hardware-red	990	Cable clamp & hardware-self attaching-2C	990G1	Cable clamp & hardware-screw mounting-2C		
SBS50GRA#10/12	Gray	#10/12	5.3/3.3	SBS50BLU	Blue	5905	Cable clamp-1 twin conductor with hardware	1466G1	Panel mount bracket				
SBS50BLU#6	Blue	#6	13.3	SBS50ORN	Orange								
SBS50BLU#10/12	Blue	#10/12	5.3/3.3	SBS50YEL	Yellow								
SBS50ORN#6	Orange	#6	13.3	SBS50RED	Red								
SBS50ORN#10/12	Orange	#10/12	5.3/3.3	SBS50GRN	Green								
SBS50YEL#6	Yellow	#6	13.3										
SBS50YEL#10/12	Yellow	#10/12	5.3/3.3										

For additional colors, contact factory

50 amp Contacts

Part Number	Description	Wire	
		AWG	sq. mm
1339G2	Contact set (2)-low det	#6	13.3
1339G3	Contact set (2)-low det	#10/12	5.3/3.3

Bushings

Part Number	Description	Wire	
		AWG	sq. mm
5912	Use with 1339G2	#6 to #8	3.3/8.4
5910	Use with 1339G2	#6 to #10/12	13.3 to 5.3/3.3
5913	Use with 1339G2	#6 to #14/16	13.3 to 2.08/1.31

ORDERING INFORMATION

Tooling

Part Number	Description
1309G4	Hand tool
1387G1	Pneumatic tool
1388G6	- die for #6 to #16 AWG
1388G7	- die for #10 to #12 AWG
1389G9	- loctor for #6 to #12 AWG

TEMPERATURE RISE CHART

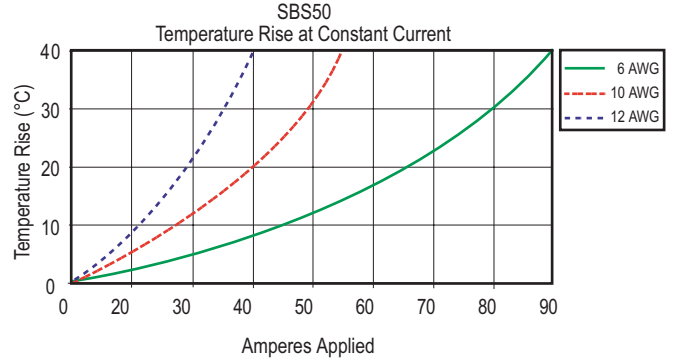

DIMENSIONS

SBS™ 50 Housing

Series	-A- mm in.	-B- mm in.	-C- mm in.	-D- mm in.	-E- mm in.	-F- mm in.	-G- mm in.	-H- mm in.	-J- mm in.
SBS™50	19.1 .75	6.3 .25	30.7 1.21	36.1 1.42	55.8 2.20	84.8 3.34	10.6 .42	16.5 .65	3.6 .14

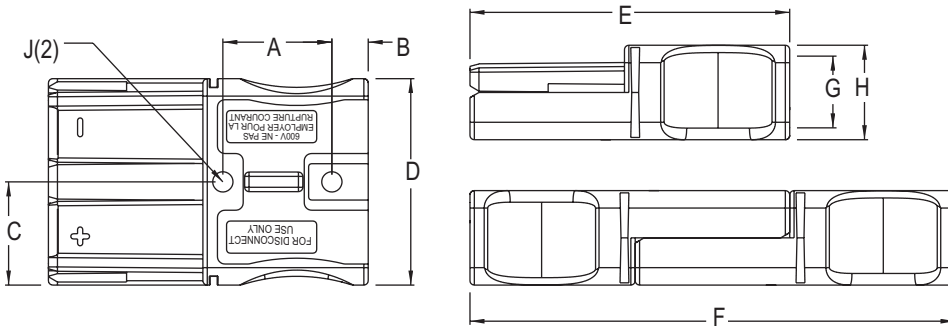

Panel Mounting Bracket

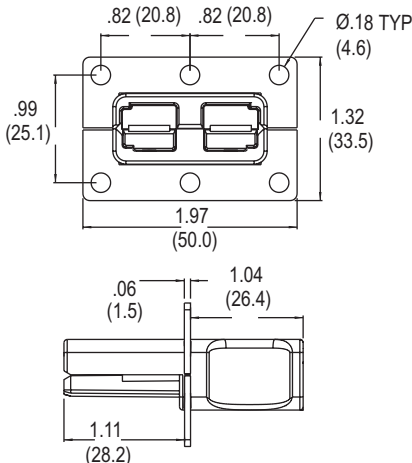

Panel Cutout With A Mounting Bracket

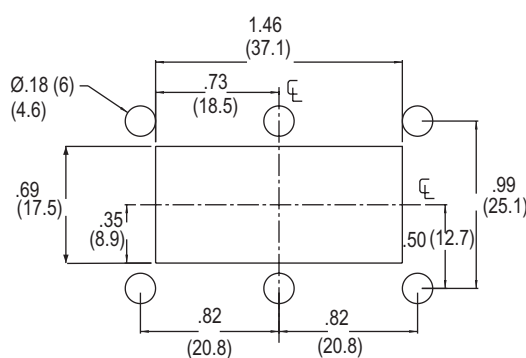

Panel Cutout Without A Mounting Bracket

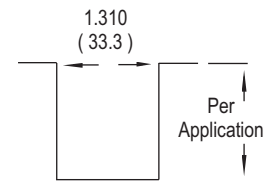

This connector is for hot-plug use at 60 amps. It contains recessed contacts and a ribbed nose housing, thus providing finger proofing in environments where human contact is a consideration. Available in different colors, this genderless connector is mechanically keyed to ensure connectors will only mate with connectors of the same color.

With the silver-plated copper contacts, there is a maximum connect/disconnect life of 10,000 cycles, with a 150 volts continuous AC or DC operation. Accessories, such as integral cable clamp and handle, provide strain relief and ease of use.

FEATURES

- **Meets UL 1950 finger probe test**

Each half offers finger proofing and can be connected to two energized sources up to 150 volts AC/DC

- **Auxiliary contacts**

Provides additional poles up to 30 amps for auxiliary power, control or sensing

- **Handle**

Eases connector use and relieves unnecessary strain on cables when disconnecting

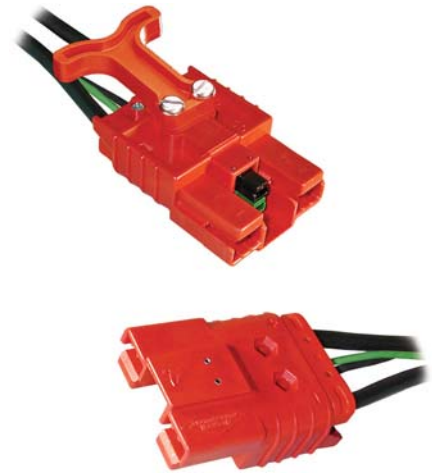

PRODUCT SPECIFICATIONS

Connector Model	SBE®80	Connector Model	SBE®80
Current rating (main contacts)	80	Insulation with standing test voltage (volts AC/DC)	1300
Largest wire size (AWG)	#6 (60 amps)	Maximum wire insulation diameter (inches)	0.44
(mm ²)	16 (80 amps)	(mm)	11.18
Maximum operating voltage AC/DC	150	Contact retention force (lbs)	50
Contact material	Silver plated copper	Life:	
Operating temperature range °C	-20° to 105°	a. No load (connect/disconnect cycles)	To 10,000
Flammability rating of housing material	UL94 V-0	b. Under load (hot plug 250 cycles @ 120V)	60A
AVG contact resistance* (microhoms)	200		

*UL rated for 65°C rated wire or cable size

ORDERING INFORMATION

Housing Only

Part Number	Housing Color
SBE80RED	Red
SBE80YEL	Yellow
SBE80ORN	Orange
SBE80WHT	White

Contacts

Part Number	Description	Wire AWG	Wire sq. mm
1339G1	Contact set (2)	#6	16

Bushings

Part Number	Description	Wire AWG	Wire sq. mm
5912	Use with 1339G1	#6 to #8	3.3/8.4
5910	Use with 1339G1	#6 to #10/12	13.3 to 5.3/3.3

Cable Clamp & Hardware

Part Number	Housing Color
SBE80CLPRED	Red

Handle/Hardware & Accessories

Part Number	Description
SBE80HDLRED	Red housing
6344	Auxiliary contact kit

Housing, Contacts, Handle, Clamp & Hardware

Part Number	Housing Color
SBE80RED16MMHDL	Red

Tooling

Part Number	Description
1309G4	Hand tool
1387G1	Pneumatic tool
1388G6	- die for #6 AWG/16 mm
1389G9	- locator for #6 AWG/16 mm

DIMENSIONS

Series	-A-		-C-		-D-		-E-		-F-	
	mm	in.	mm	in.	mm	in.	mm	in.	mm	in.
SBE®80	46.0	1.81	14.6	.58	49.5	1.95	58.9	2.32	112.3	4.41

Series	-G-		-H-		-I-	
	mm	in.	mm	in.	mm	in.
SBE®80	26.3	1.03	5.1	.20	10.6	.42

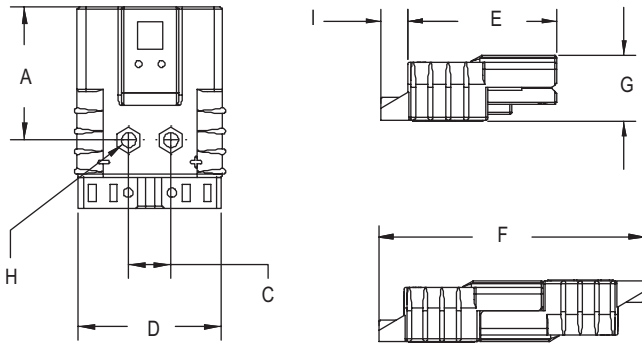

TEMPERATURE RISE CHART

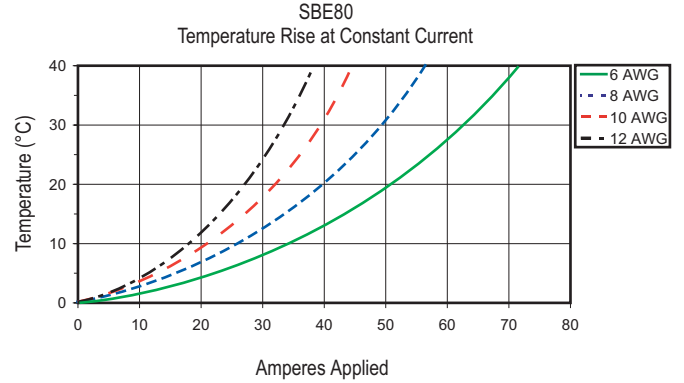

The innovative SBE® connectors provide cost-effective reliability, design flexibility and safety for your products' manufacture, installation and maintenance.

APP's 2 pole connector is available with a 160 amp rating, 150 Volts continuous AC or DC operation. There are SBE® connectors for many applications and wire sizes, 1/0 to 35 mm (53.5 mm to 35 mm). Mechanical keys ensure connectors will only mate with connectors of the same color. Different color housings are selected to identify voltages, thus preventing mismatching of the power supply system.

FEATURES

- Finger proofing**
Helps prevent fingers (or probes) from accidentally touching live contacts. SBE®160 connector meets EN1175 requirements.
- Auxiliary contacts**
Provides ability to incorporate a secondary sensor control circuit
- Optional air supply system**
Supplies air to battery during charging



PRODUCT SPECIFICATIONS

Connector Model	SBE®160	Connector Model	SBE®160
UL Current Rating (Amperes)*	160*	Life	
UL Voltage Ratings (Volts)	150*	a. No load (Contact/Disconnect Cycles)	To 10,000
Contact Barrel Wire Size (AWG)	1/0 to 35 mm	b. Under Load (Hot Plug 250 cycles @ 120V)	75A
(mm ²)	53.5 to 35	Avg. Connection/Disconnect (lbs)	25
Maximum Wire Insulation Diameter (inches)	0.75	Operating Temperature Range °C**	-20° to 105°
(mm)	19.05	Flammability Rating of Housing Material	UL94 V-0
AVG Contact Resistance* (micro-ohms)	100		
Insulation Withstanding Test Voltage (Volts AC/DC)	1300		
Contact Retention Force (lbs)	300		

* UL Rated for 65°C rated wire or cable size
** Contact factory for higher temperature rated connector
*** TUV on SBE160
SBE®, UL and CSA Reference: This equipment is an Underwriters Laboratories Inc® recognized component. It is also listed by the Canadian Standards Association as certified.

ORDERING INFORMATION

2 Pole Housing, 160 amp Contacts, & Auxiliary Contacts

Part Number	Housing Color	Wire sq. mm
E6370G2	Gray	35
E6371G2	Blue	35
E6372G2	Orange	35
E6373G2	Yellow	35
E6378G2	Red	35
E6387G2	Green	35
E6388G2	Black	35

2 Pole Housing & Contacts

Part Number	Housing Color	Wire sq. mm
E6374G2	Gray	35
E6375G2	Blue	35
E6376G2	Orange	35
E6377G2	Yellow	35

2 pole housing & contacts continued

Part Number	Housing Color	Wire sq. mm
E6379G2	Red	35
E6391G2	Green	35
E6389G2	Black	35

Housings Only

Part Number	Color
E6380G1	Gray
E6381G1	Blue
E6382G1	Orange
E6383G1	Yellow
E6385G1	Red
E6390G1	Green
E6392G1	Black

Contacts

Part Number	Description	AWG	Wire sq. mm
6384G2	Contact set (2)	N/A	35
6384G1	Contact set (2)	1/0	53.5

Accessories

Part Number	Description
6344	Auxiliary contact kit
6337G1	Charger key
995G1	Handle with hardware "A" frame
993G2	Manual release-battery bracket with hardware
994G2	Manual release-charger/truck bracket with hardware
945G2	Cable clamps-use alone with manual release or "A" frame handle

Part Number	Description
6367G1	#16/12(1.31/3.31mm)-for battery-pin
6366G2	#16/12(1.31/3.31mm)-for charger & truck-tube

...continued on next page

ORDERING INFORMATION

accessories continued

Bushings

Part Number	Description	Wire	
		AWG	sq. mm
5687	For use with 6384G1	1/0 to #1	53.5 to 42.41
5690	For use with 6384G1	1/0 to #2	53.5 to 33.62
5693	For use with 6384G1	1/0 to #4	53.5 to 21.15
5663	For use with 6384G1	1/0 to #6	53.5 to 13.30
5648	For use with 6384G1	1/0 to #10	53.5 to 5.26
5920	For use with 6384G2	35mm to 16mm	

Tooling

Part Number	Description
969P1	Extraction tool-insulated handle
111038G2	Contact insertion/extraction tool for auxiliary contact kit
1368	Hand tool for 1/0 to 35mm (53.5/35)
1387G1	Pneumatic tool
1388G3	- die for 1/0 to #10 (53.5/5.26)
1389G3	- locator for 1/0 to #10 (53.5/5.26)
111038G2	Insertion/extraction tool

DIMENSIONS

SBE® Housing

Series	-A-		-B-		-C-		-D-	
	mm	in.	mm	in.	mm	in.	mm	in.
SBE®160	49.2	1.94	28.5	1.13	15.9	0.63	71.2	2.80

Series	-E-		-F-		-G-	
	mm	in.	mm	in.	mm	in.
SBE®160	92.2	3.63	146.3	5.76	25.4	1.00

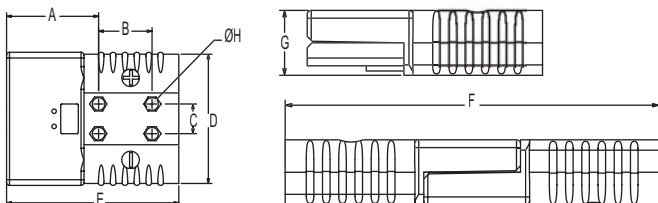

Contacts

	-A-		-B-		-C-		-D-		-E-	
	mm	in.	mm	in.	mm	in.	mm	in.	mm	in.
6384G1	59.2	2.33	13	.51	11.1	.44	21.3	.84	12.7	.50
6384G2	59.2	2.33	13	.51	9.5	.38	21.3	.84	12.7	.50

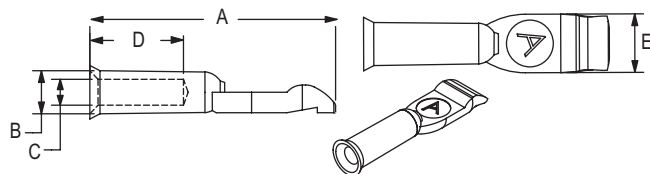

TEMPERATURE RISE CHARTS

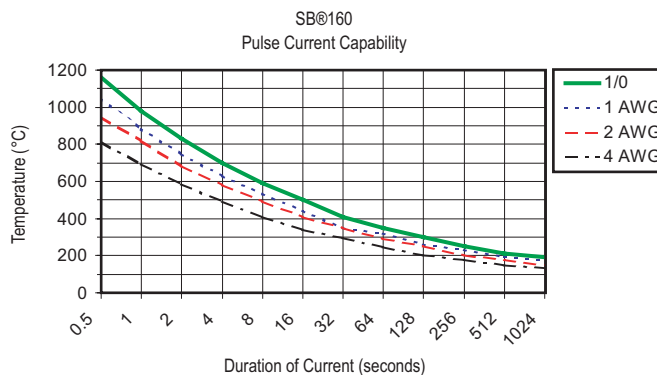
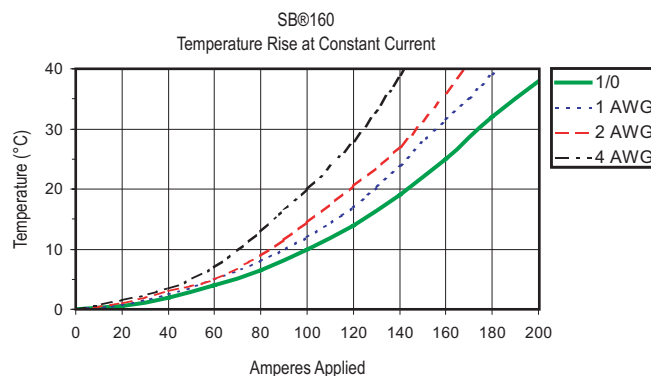

The innovative SBE® connectors provide cost-effective reliability, design flexibility and safety for your products' manufacture, installation and maintenance.

APP's 2 pole connector is available with a 320 amp rating, 150 Volts continuous AC or DC operation. There are SBE® connectors for many applications and wire sizes, 2/0 to 300 mcm (33.6 mm to 152 mm). Mechanical keys ensure connectors will only mate with connectors of the same color. Different color housings are selected to identify voltages, thus preventing mismatching of the power supply system.

FEATURES

- **Genderless design**
Makes assembly quick and easy and reduces number of parts stocked
- **Auxiliary contacts**
Provides ability to incorporate a secondary circuit
- **Air supply system**
Supplies air to battery during charging



PRODUCT SPECIFICATIONS

Connector Model	SBE ®320	Connector Model	SBE ®320
UL Current Rating (Amperes)*	320*	Life	
UL Voltage Ratings (Volts)	150*	a. No load (Contact/Disconnect Cycles)	To 10,000
Contact Barrel Wire Size (AWG) (mm ²)	2/0 to 300 mcm 67.4 to 152	b. Under Load (Hot Plug 250 cycles @ 120V)	100A*
Maximum Wire Insulation Diameter (inches) (mm)	1.10 27.94	Avg. Connection/Disconnect (lbs)	30
AVG Contact Resistance* (micro-ohms)	50	Operating Temperature Range °C**	-20° to 105°
Insulation Withstanding Test Voltage (Volts AC/DC)	1300	Flammability Rating of Housing Material	UL94 V-0
Contact Retention Force (lbs)	500		

* UL Rated for 65°C rated wire or cable size
** Contact factory for higher temperature rated connector
*** TUV on SBE®320
SBE®, UL and CSA Reference: This equipment is an Underwriters Laboratories Inc® recognized component. It is also listed by the Canadian Standards Association as certified.

ORDERING INFORMATION

2 Pole Housing & 320 amp Contacts

Part Number	Housing Color	Wire	
		AWG	sq. mm
E6334G1	Brown	2/0	67.4
E6334G2	Brown	3/0	85.0
E6334G6	Brown	#2	33.6
E6335G1	Purple	2/0	67.4
E6335G2	Purple	3/0	85.0
E6335G6	Purple	#2	33.6
E6345G1	Gray	2/0	67.4
E6345G2	Gray	3/0	85.0
E6345G6	Gray	#2	33.6
E6346G1	Blue	2/0	67.4
E6346G2	Blue	3/0	85.0
E6346G6	Blue	#2	33.6
E6347G1	Red	2/0	67.4
E6347G2	Red	3/0	85.0
E6347G6	Red	#2	33.6
E6348G1	Green	2/0	67.4
E6348G2	Green	3/0	85.0
E6348G6	Green	#2	33.6
E6363G1	Black	2/0	67.4
E6363G2	Black	3/0	85.0
E6363G6	Black	#2	33.6

2 pole housing & 320 amp contacts continued

Part Number	Housing Color	Wire	
		AWG	sq. mm
E6364G1	Yellow	2/0	67.4
E6364G2	Yellow	3/0	85.0
E6364G6	Yellow	#2	33.6
E6369G1	Orange	2/0	67.4
E6369G2	Orange	3/0	85.0
E6369G6	Orange	#2	33.6

2 Pole Housing, Contacts & Auxiliary Contacts

Part Number	Housing Color	Wire	
		AWG	sq. mm
E6332G1	Brown	2/0	67.4
E6332G2	Brown	3/0	85.0
E6332G6	Brown		35.0
E6333G1	Purple	2/0	67.4
E6333G2	Purple	3/0	85.0
E6333G6	Purple		35.0
E6340G1	Gray	2/0	67.4
E6340G2	Gray	3/0	85.0

2 pole housing, contacts & auxiliary contacts continued

Part Number	Housing Color	Wire	
		AWG	sq. mm
E6340G6	Gray		35.0
E6341G1	Blue	2/0	67.4
E6341G2	Blue	3/0	85.0
E6341G6	Blue		35.0
E6342G1	Red	2/0	67.4
E6342G2	Red	3/0	85.0
E6342G6	Red		35.0
E6343G1	Green	2/0	67.4
E6343G2	Green	3/0	85.0
E6343G6	Green		35.0
E6359G1	Black	2/0	67.4
E6359G2	Black	3/0	85.0
E6359G6	Black		35.0
E6360G1	Yellow	2/0	67.4
E6360G2	Yellow	3/0	85.0
E6360G6	Yellow		35.0
E6368G1	Orange	2/0	67.4
E6368G2	Orange	3/0	85.0
E6368G6	Orange		35.0

...continued on back page

ORDERING INFORMATION

Housings Only

Part Number	Color
E6350	Gray
E6351	Blue
E6350	Gray
E6351	Blue
E6352	Red
E6353	Green
E6361	Black
E6362	Yellow
E6339	Orange
E6336	Brown
E6349	Purple

Contacts

Part Number	Description	Wire	
		AWG	sq. mm
6354	Contact set (2)	2/0	67.4
6355	Contact set (2)	3/0	85.0
6356	Contact set (2)	4/0	107.2
6394	Contact set (2)		35.0
1341G1	DIN standard		50.0
1341G2	DIN standard		70.0
1341G3	DIN standard		95.0

Bushings

Part Number	Description	Wire	
		AWG	sq. mm
5687	For use with 6354 contact & 5918 bushing	1/0 to #1	53.5 to 42.41
5690	For use with 6354 contact & 5918 bushing	1/0 to #2	53.5 to 33.62
5693	For use with 6354 contact & 5918 bushing	1/0 to #4	53.5 to 21.15
5663	For use with 6354 contact & 5918 bushing	1/0 to #6	53.5 to 13.30
5648	For use with 6354 contact & 5918 bushing	1/0 to #10	53.5 to 5.26
5918	For use with 6354 contact	2/0 to 1/0	67.43 to 53.5
5920	For use with 6394 contact		35 to 16mm

Accessories

Part Number	Description
6367G1	Pin & tube kit #16/12 (1.31/3.31mm)-for battery-pin
6366G2	Pin & tube kit #16/12 (1.31/3.31mm)-for charger & truck-tube
6337G1	Charger key
995G2	Handle with hardware "A" frame
993G1	Manual release-battery bracket with hardware
994G1	Manual release-charger/truck bracket with hardware
911G2	Cable clamps-use alone with manual release or "A" frame handle
6305G1	Auxiliary contact kit with contact part number 1331
6310G1	Auxiliary contact kit with contact part number 1332

Tooling

Part Number	Description
970P1	Extraction tool-insulatd handle
111038G2	Contact insertion/extraction tool for auxiliary contact kit
1368	Hand tool for 1/0 to 95mm (53.5/95)
1387G1	Pneumatic tool
1388G2	- die for 1/0 to 4/0 (53.5/107.2)
1389G2	- locator for 1/0 to 4/0 (53.5/107.2)

Consult factory for additional tooling information



All Data Subject To Change Without Notice

TEMPERATURE RISE CHARTS

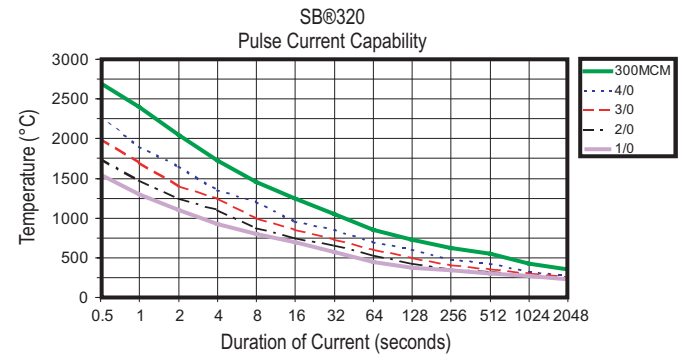
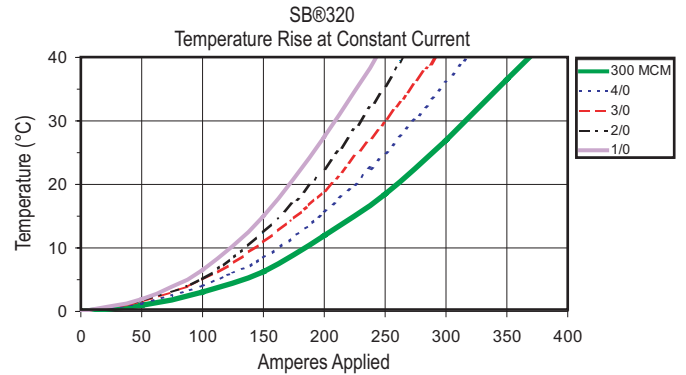

DIMENSIONS

SBE® Housing

Series	-A-		-B-		-C-		-D-	
	mm	in.	mm	in.	mm	in.	mm	in.
SBE®160	61.9	2.44	28.5	1.13	15.9	.63	85.7	3.37

Series	-E-		-F-		-G-	
	mm	in.	mm	in.	mm	in.
SBE®160	125.4	4.94	200.0	7.88	33.3	1.31

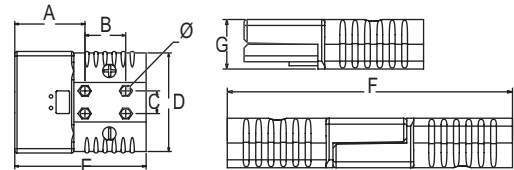

Contacts

	-A-		-B-		-C-		-D-		-E-	
	mm	in.	mm	in.	mm	in.	mm	in.	mm	in.
6354	78.7	3.10	16.3	.64	12.4	.49	31.8	1.25	20.6	.81
6355	78.7	3.10	17.9	.70	14.7	.58	31.8	1.25	20.6	.81
6356	78.7	3.10	19.1	.75	16.3	.64	31.8	1.25	20.6	.81
6394	77.0	3.03	13.0	.51	9.5	.38	31.8	1.25	20.6	.81
1341G1	67.3	2.65	14.5	.57	10.9	.43	18.9	.75	20.6	.81
1341G2	66.8	2.63	17.3	.68	13.0	.51	20.1	.79	20.6	.81
1341G3	70.9	2.79	19.8	.78	15.0	.59	23.9	.94	20.6	.81

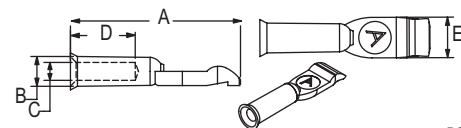

DS-SBE320 REV01

The SBE 700 connector is the newest member of Anderson Power Products family of genderless quick disconnects connectors. The product is UL listed and certified to meet EPRI Conductive Fast Charge Connector specifications, with a continuous current capacity of 700 amperes. The SBE 700 allows the use of a single connector to meet the tough demands of high current traction battery rapid charging.

Rugged and durable, the connector is capable of 10,000 mating cycles. The SBE 700 connector is keyed and touch safe offering improved user safety. The integrated non-metallic cable clamp further improves user safety by restricting cable insulation creep and increases the ruggedness of the connector/cable assembly. Up to ten optional auxiliary contacts are also available for sensing and communications.

The SBE 700 is designed and manufactured to the same high standards and stringent specifications that have made APP the leader in high power connectors.

FEATURES

- **700 amp continuous current**

The SBE 700 eliminates the need for more than one connector to achieve high current charging

- **Up to ten optional auxiliary contacts**

Provide sensing and communications circuits for any battery charging/monitoring system

- **Field replaceable power contacts utilizes industry standard cables**

Tool removable, crimp contacts use 250 MCM or 4/0 cables eliminating high cost specialty cables

- **Touch safe, keyed design**

The connector body prevents inadvertent touching of the main power contacts. Connector specific keying can be ordered to insure only matching connectors can be mated



PRODUCT SPECIFICATIONS

Power Contacts		Signal / Auxiliary Contacts	
Number of High Current Contacts	2	Number of Signal/Auxiliary Contacts (Powerpole and/or Pin & Socket)	0 to 10
Contact Barrel Size (AWG or MCM) (flexible Stranded Class I, K, M, Types W or EV)	2 x 4/0 = 600amp 2 x 250MCM = 700 amp	Contact Wire Size (AWG)	10 to 20
UL Current Rating (amperes DC)	700	Contact Wire Size (mm)	4 to .5
Contact to Wire Retention Force	250 pounds	Contact Current Rating (amperes DC)	30
Life at No Load (Contact Connect/Disconnect Cycles)	10,000	Control pilot delay vs. power contacts (millisecond)	35
Finger proof	UL 1977	Contact housing retention force (lbs.)	25
Complete Unit		Life at No Load (Contact Connect/Disconnect Cycles)	10,000
Voltage Rating (volts DC)	150		
Insulation Withstanding Test Voltage (volts DC)	1300		
Operating Temperature Range °C	-40 to +50		
Temperature Rise at Nominal Load °C	50		
Average Insertion/extraction Force (lbs. with handle)	30		
Flammability Rating of Housing Material	PBT, UL94 HB		

ORDERING INFORMATION

Connectors

Part Number	Description
700G1	700A housing, contacts, and clamp
707G1	700A housing, contacts, clamp, and release lever & bracket for battery connector
708G1	700A housing, contacts, clamp, and latch plate for truck/charger connector
709G1	700A housing, contacts, clamp, release lever & bracket for battery connector and auxiliary housing
710G1	700A contacts, clamp, latch plate for truck/charger connector and auxiliary housing

Components

Part Number	Description
702G1	Housing only
703G1	Auxiliary contact housing only (ten auxiliary connectors and/or spacers needed to fill auxiliary housing)
704G1	Cable Clamp only
705G1	Release lever & bracket for battery connector (mates with 706G1)
706G1	Latch plate for truck/charger connector (mates with 705G1)
6170G1	700A Contact Set
5954	Bushing 4/0 AWG (107.2 mm)

Powerpole® Auxiliary Connectors

Part Number	Description
1327	Red housing
1327G5	Green housing
1327G6	Black housing
1327G7	White housing
1327G8	Blue housing
1327G16	Yellow housing
1327G17	Orange housing
1327G18	Gray housing
1327G21	Brown housing
1327G22	Pink housing
1327G23	Purple housing
1399G6	Red short spacer without hole
1331	30 amp contact 12/16 AWG (3.3/1.3 mm)
1332	15 amp contact 16/20 AWG (1.3/.52 mm)

Tooling

Part Number	Description
Y750	Hydraulic Crimp Tool - FCI Burndy
U34RT	Crimp Die - FCI Burndy

DIMENSIONS

Housing

	-A-	-B-	-C-	-D-	-E-	-F-	-G-
inches	7.0	2.13	5.69	5.50	5.09	2.24	1.25
mm	177.8	54.1	144.5	140.0	129.3	56.9	31.8

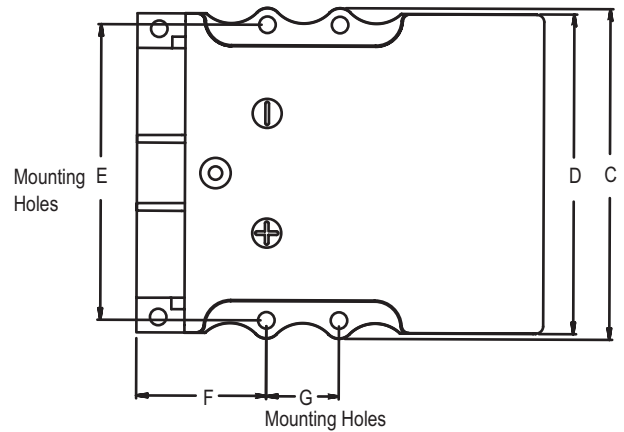
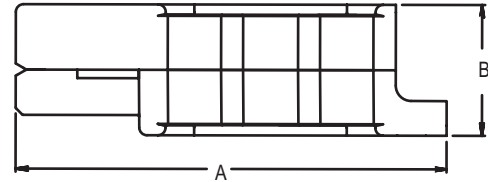

TEMPERATURE RISE CHART

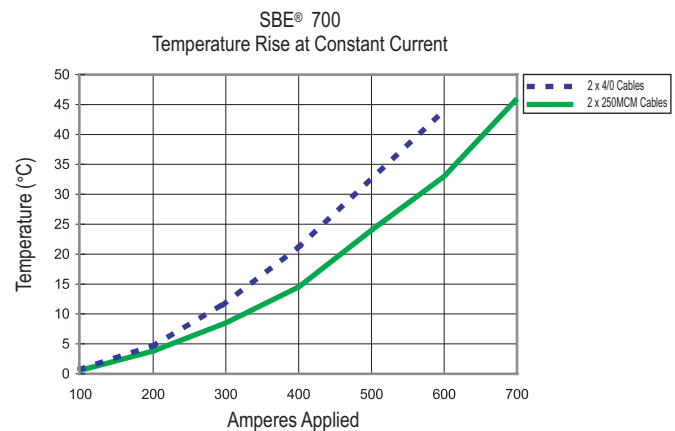

FEATURES

- **Mechanical keyed housings**

Prevents two different voltage coded color housings from mating-(eliminates possibility of mismatching power supplies and electrical outlets.)

- **Auxiliary contacts**

Provides ability to incorporate a secondary sensor control circuit

- **Single-piece housing and unitized construction**

Provides industrial quality and durability

- **Optional air supply system**

Supplies air to battery during charging

- **Genderless design**

Makes assembly quick and easy and reduces number of parts stocked

- **Optional mechanical release**

Aids mating and unmating for high cycle battery charging

- **UL94 V-0 housing material**

Provides security in knowledge that the connector chosen meets strict UL flammability ratings



PRODUCT RANGE

UL Current Rating (Amperes)*	175 to 350*
UL Voltage Ratings (Volts)	600*
Contact Barrel Wire Size (AWG)	1/0 to 300 mcm
(mm ²)	53.5 to 152
Maximum Wire Insulation Diameter (inches)	0.75 to 1.10
(mm)	19.05 to 227.94
AVG Contact Resistance* (micro-ohms)	100 to 50
Insulation Withstanding	2200
Test Voltage (Volts AC/DC)	
Contact Retention Force (lbs)	300 to 500
Life	
a. No load (Contact/Disconnect Cycles)	To 10,000
b. Under Load (Hot Plug 250 cycles @ 120V)	75A to 100A*
Avg. Connection/Disconnect (lbs)	25 to 30
Operating Temperature Range °C**	-20° to 105°
Flammability Rating of Housing Material	UL94 V-0

* UL Rated for 65°C rated wire or cable size

** Contact factory for higher temperature rated connectors

SBX® UL and CSA Reference: This equipment is an Underwriters Laboratories Inc® recognized component. It is also listed by the Canadian Standards Association as certified.

Recommended Voltage Key Color Code

Voltage	12V	18V	24V	36V	48V	72V	80V	96V	120V	144V
Color	Yellow	Orange	Red	Gray	Blue	Green	Black	Brown	Purple	White

PRODUCT INFORMATION

Invented by Anderson Power Products®, the innovative SBX® connectors provide cost-effective reliability, design flexibility and safety for your products' manufacture, installation and maintenance. APP's 2 pole connectors are available from 175 or 350 amp ratings for use to 600 Volts continuous AC or DC operation. There are SBX® connectors for many applications and wire sizes, 1/0 (53.5mm) to 300 mcm (152mm). Mechanical keys ensure connectors will only mate with connectors of the same color. Different color housings are selected to identify voltages, thus preventing mismatching of the power supply system.

The housings are interchangeable, genderless interconnects. Insert contacts into housings and plug together for a clever, simple and low-cost solution to power interconnection.

Markets: UPS Systems, Telecommunications, Forklift Trucks, Wheelchairs, EV, Chargers, Power Electronics & Much More.

The innovative SBX® connectors provide cost-effective reliability, design flexibility and safety for your products' manufacture, installation and maintenance.

APP's 2 pole connector is available with a 175 amp rating, 600 Volts continuous AC or DC operation. There are SBX® connectors for many applications and wire sizes, 1/0 to 35 mm (53.5 mm to 35 mm). Mechanical keys ensure connectors will only mate with connectors of the same color. Different color housings are selected to identify voltages, thus preventing mismatching of the power supply system.

FEATURES

- Mechanical keyed housings**
Prevents accidental mating of components operating at different voltage levels
- Auxiliary contacts**
Provides ability to incorporate a secondary sensor control circuit
- Optional mechanical release**
Aids mating and unmating for high cycle battery charging



PRODUCT SPECIFICATIONS

Connector Model	SBX®175	Connector Model	SBX®175
UL Current Rating (Amperes)*	175*	Life	
UL Voltage Ratings (Volts)	600*	a. No load (Contact/Disconnect Cycles)	To 10,000
Contact Barrel Wire Size (AWG) (mm ²)	1/0 to 35 mm 53.5 to 35	b. Under Load (Hot Plug 250 cycles @ 120V)	75A
Maximum Wire Insulation Diameter (inches) (mm)	0.75 19.05	Avg. Connection/Disconnect (lbs)	25
AVG Contact Resistance* (micro-ohms)	100	Operating Temperature Range °C**	-20° to 105°
Insulation Withstanding Test Voltage (Volts AC/DC)	2200	Flammability Rating of Housing Material	UL94 V-0
Contact Retention Force (lbs)	300		

* UL Rated for 65°C rated wire or cable size
** Contact factory for higher temperature rated connector
SBX®, UL and CSA Reference: This equipment is an Underwriters Laboratories Inc® recognized component. It is also listed by the Canadian Standards Association as certified.

ORDERING INFORMATION

2 Pole Housing, 175 amp Contacts, & Auxiliary Contacts

Part Number	Housing Color	Wire	
		AWG	sq. mm
6370G1	Gray	1/0	53.5
6371G1	Blue	1/0	53.5
6372G1	Orange	1/0	53.5
6373G1	Yellow	1/0	53.5
6378G1	Red	1/0	53.5
6387G1	Green	1/0	53.5
6378G2	Red	35	
6387G2	Green	35	
6370G2	Gray	35	
6371G2	Blue	35	
6372G2	Orange	35	
6373G2	Yellow	35	

2 Pole Housing & Contacts

Part Number	Housing Color	Wire	
		AWG	sq. mm
6374G1	Gray	1/0	53.5
6375G1	Blue	1/0	53.5
6376G1	Orange	1/0	53.5
6377G1	Yellow	1/0	53.5
6379G1	Red	1/0	53.5
6391G1	Green	1/0	53.5
6374G2	Gray	35	
6375G2	Blue	35	
6376G2	Orange	35	
6377G2	Yellow	35	
6379G2	Red	35	
6391G2	Green	35	

Housings Only

Part Number	Color	Wire	
		AWG	sq. mm
6380G1	Gray		
6381G1	Blue		
6382G1	Orange		
6383G1	Yellow		
6385G1	Red		
6390G1	Green		

Contacts

Part Number	Description	Wire	
		AWG	sq. mm
6384G1	Contact set (2)	1/0	53.5
6384G2	Contact set (2)	N/A	35

HEADQUARTERS: 13 Pratts Junction Road, P.O. Box 579, Sterling, MA 01564 T:978-422-3600 F:978-422-3700

EUROPE: Rathealy Road, Fermoy Co. Cork, Ireland T:353-(0)25-32277 F:353-(0)25-32296

ASIA/PACIFIC: IDEAL Anderson Asia Pacific Ltd., Unit 922-928 Topsail Plaza, 11 On Sum Street, Shatin N.T., Hong Kong

T:852-2636-0836 F:852-2635-9036

www.andersonpower.com

ORDERING INFORMATION

Accessories

Part Number	Description
6344	Auxiliary contact kit
6367G1	Pin & tube kit #16/12 (1.31/3.31mm)
6337G1	Charger key
6367G1	Charger key & socket
995G1	Handle with hardware "A" frame
993G2	Manual release-battery bracket with hardware
994G2	Manual release-charger/truck bracket with hardware
945G2	Cable clamps-use alone with manual release or "A" frame handle

Bushings

Part Number	Description	Wire	
		AWG	sq. mm
5687	For use with 6384G1	1/0 to #1	53.5 to 42.41
5690	For use with 6384G1	1/0 to #2	53.5 to 33.62
5693	For use with 6384G1	1/0 to #4	53.5 to 21.15
5663	For use with 6384G1	1/0 to #6/8	53.5 to 13.30
5648	For use with 6384G1	1/0 to #10	53.5 to 5.26
5920	For use with 6384G2	35mm to 16mm	

Tooling

Part Number	Description
969P1	Extraction tool-insulated handle
111038G2	Contact insertion/extraction tool for auxiliary contact kit
1368	Hand tool for 1/0 to 35mm (53.5/35)
1387G1	Pneumatic tool
1388G3	- die for 1/0 to #10 (53.5/5.26)
1389G3	- locator for 1/0 to #10 (53.5/5.26)
1387G2	- Pneumatic tool
1303G4	- die for #4 (21.1)
1304G4	- locator for #4 (21.1)

TEMPERATURE RISE CHARTS

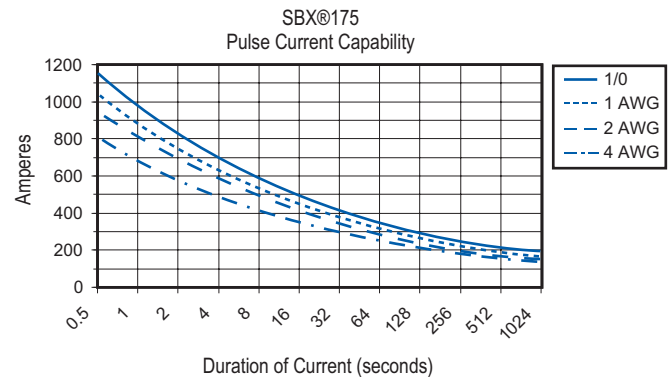
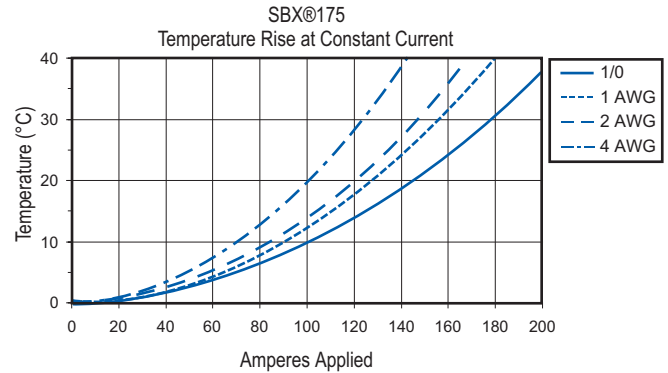

DIMENSIONS

SBX® Housing

Series	-A-		-B-		-C-		-D-	
	mm	in.	mm	in.	mm	in.	mm	in.
SBX®175	49.2	1.94	28.5	1.13	15.9	0.63	71.2	2.80

Series	-E-		-F-		-G-		-H-	
	mm	in.	mm	in.	mm	in.	mm	in.
SBX®175	85.3	3.63	146.3	5.76	25.4	1.00	6.7	0.26

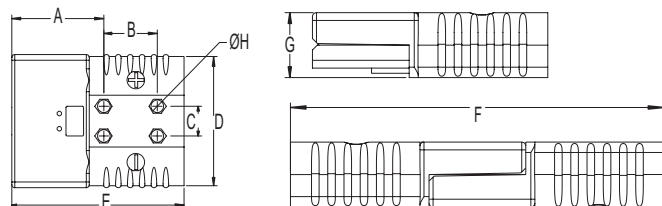

Contacts

	-A-		-B-		-C-		-D-		-E-	
	mm	in.	mm	in.	mm	in.	mm	in.	mm	in.
6384G1	59.2	2.33	13	.51	11.1	.44	21.3	.84	12.7	.50
6384G2	59.2	2.33	13	.51	9.5	.38	21.3	.84	12.7	.50

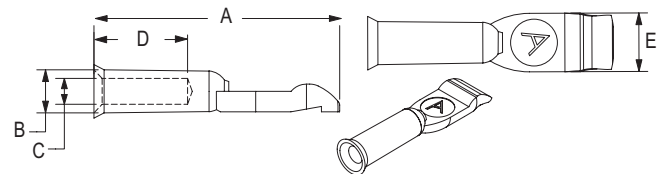

The innovative SBX[®] connectors provide cost-effective reliability, design flexibility and safety for your products' manufacture, installation and maintenance.

APP's 2 pole connector is available with a 350 amp rating, 600 Volts continuous AC or DC operation. There are SBX[®] connectors for many applications and wire sizes, 2/0 to 300 mm (67.4 mm to 152 mm). Mechanical keys ensure connectors will only mate with connectors of the same color. Different color housings are selected to identify voltages, thus preventing mismatching of the power supply system.

FEATURES

- **Mechanical keyed housings**
Prevents accidental mating of components operating at different voltage levels
- **Auxiliary contacts**
Provides ability to incorporate a secondary sensor control circuit
- **Optional mechanical release**
Aids mating and unmating for high cycle battery charging



PRODUCT SPECIFICATIONS

Connector Model	SBX [®] 350	Connector Model	SBX [®] 350
UL Current Rating (Amperes)*	350*	Life	
UL Voltage Ratings (Volts)	600*	a. No load (Contact/Disconnect Cycles)	To 10,000
Contact Barrel Wire Size (AWG) (mm ²)	2/0 to 300 mcm 67.4 to 152	b. Under Load (Hot Plug (250 cycles @ 120V)	100A
Maximum Wire Insulation Diameter (inches) (mm)	1.10 27.94	Avg. Connection/Disconnect (lbs)	30
AVG Contact Resistance* (micro-ohms)	50	Operating Temperature Range °C**	-20° to 105°
Insulation Withstanding Test Voltage (Volts AC/DC)	2200	Flammability Rating of Housing Material	UL94 V-0
Contact Retention Force (lbs)	500		

* UL Rated for 65°C rated wire or cable size
** Contact factory for higher temperature rated connector
SBX[®], UL and CSA Reference: This equipment is an Underwriters Laboratories Inc[®] recognized component. It is also listed by the Canadian Standards Association as certified.

ORDERING INFORMATION

2 Pole Housing, 350 amp Contacts, & Auxiliary Contacts

Part Number	Housing Color	Wire AWG	Wire sq. mm
6340G1	Gray	2/0	67.4
6340G2	Gray	3/0	85.0
6340G3	Gray	4/0	107.2
6340G5	Gray	300mcm	152.0
6341G1	Blue	2/0	67.4
6341G2	Blue	3/0	85.0
6341G3	Blue	4/0	107.2
6341G5	Blue	300mcm	152.0
6342G1	Red	2/0	67.4
6342G2	Red	3/0	85.0
6342G3	Red	4/0	107.2
6342G5	Red	300mcm	152.0
6343G1	Green	2/0	67.4
6343G2	Green	3/0	85.0
6343G3	Green	4/0	107.2

2 pole housing, 350 amp contacts, & auxiliary contacts continued

Part Number	Housing Color	Wire AWG	Wire sq. mm
6343G5	Green	300mcm	152.0
6359G1	Black	2/0	67.4
6359G2	Black	3/0	85.0
6359G3	Black	4/0	107.2
6359G5	Black	300mcm	152.0
6360G1	Yellow	2/0	67.4
6360G2	Yellow	3/0	85.0
6360G3	Yellow	4/0	107.2
6360G5	Yellow	300mcm	152.0
6368G1	Orange	2/0	67.4
6368G2	Orange	3/0	85.0
6368G3	Orange	4/0	107.2
6368G5	Orange	300mcm	152.0

2 Pole Housing & 350 amp Contacts

Part Number	Housing Color	Wire AWG	Wire sq. mm
6345G1	Gray	2/0	67.4
6345G2	Gray	3/0	85.0
6345G3	Gray	4/0	107.2
6345G5	Gray	300mcm	152.0
6346G1	Blue	2/0	67.4
6346G2	Blue	3/0	85.0
6346G3	Blue	4/0	107.2
6346G5	Blue	300mcm	152.0
6347G1	Red	2/0	67.4
6347G2	Red	3/0	85.0
6347G3	Red	4/0	107.2
6347G5	Red	300mcm	152.0
6348G1	Green	2/0	67.4
6348G2	Green	3/0	85.0
6348G3	Green	4/0	107.2
6348G5	Green	300mcm	152.0

...continued on back page

ORDERING INFORMATION

continued

2 Pole Housing & 350 amp Contacts

Part Number	Housing Color	Wire	
		AWG	sq. mm
6363G2	Black	3/0	85.0
6363G3	Black	4/0	107.2
6363G5	Black	300mcm	152.0
6364G1	Yellow	2/0	67.4
6364G2	Yellow	3/0	85.0
6364G3	Yellow	4/0	107.2
6364G5	Yellow	300mcm	152.0
6369G1	Orange	2/0	67.4
6369G2	Orange	3/0	85.0
6369G3	Orange	4/0	107.2
6369G5	Orange	300mcm	152.0

2 Pole Housing, 350 amp 35mm Contacts

Part Number	Housing Color	Wire
		sq. mm
6345G6	Gray	35
6346G6	Blue	35
6347G6	Red	35
6348G6	Green	35
6363G6	Black	35
6364G6	Yellow	35
6369G6	Orange	35

2 Pole Housing, 350 amp 35mm Contacts & Auxiliary Contacts

Part Number	Housing Color	Wire
		sq. mm
6340G6	Gray	35
6341G6	Blue	35
6342G6	Red	35
6343G6	Green	35
6359G6	Black	35
6360G6	Yellow	35
6380G6	Orange	35

Housings Only

Part Number	Housing Color
	6350
6351	Blue
6352	Red
6353	Green
6361	Black
6362	Yellow
6339	Orange

Contacts

Part Number	Description	Wire	
		AWG	sq. mm
6354	Contact set (2)	2/0	67.4
6355	Contact set (2)	3/0	85.0
6356	Contact set (2)	4/0	107.2
6358	Contact set (2)	300 mcm	152.0
6394	Contact set (2)-thin wall	N/A	35

Bushings

Part Number	Description	Wire	
		AWG	sq. mm
5918	For use with 6354	2/0 to 1/0	67.4 to 53.5

Accessories

Part Number	Description
6305G1	Auxiliary contact kit with contact part number 1331
6310G1	Auxiliary contact kit with contact part number 1332
6337G1	Charger key
6367G1	Charger key & pin
6366G2	Charger key & socket
995G2	Handle with hardware "A" frame
993G1	Manual release-battery bracket with hardware
994G1	Manual release-charger/truck bracket with hardware
911G2	Cable clamps-use alone with manual release or "A" frame handle

Tooling

Part Number	Description
970P1	Extraction tool-insulated handle
111038G2	Auxiliary contact, insertion/extraction tool

TEMPERATURE RISE CHARTS

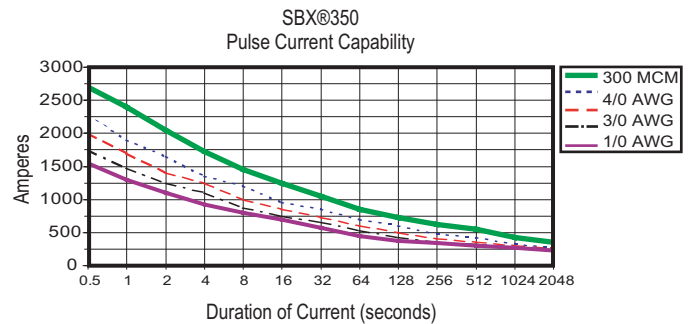
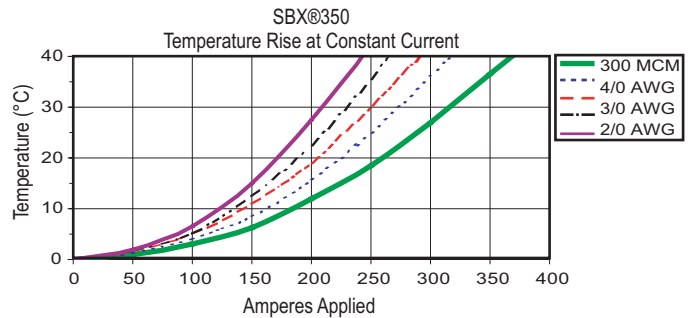

DIMENSIONS

SBX[®] Housing

Series	-A-		-B-		-C-		-D-	
	mm	in.	mm	in.	mm	in.	mm	in.
SBX [®] 350	61.9	2.44	28.5	1.13	15.9	.63	85.7	3.37

Series	-E-		-F-		-G-		-H-	
	mm	in.	mm	in.	mm	in.	mm	in.
SBX [®] 350	125.4	4.94	200.0	7.88	33.3	1.31	6.7	.26

